

**LOS ANGELES COUNTY
DEPARTMENT OF PUBLIC WORKS**

BENCH MARK LIST



RIVERA QUAD

1994 ADJUSTMENT

NGVD 29 DATUM

PREFACE

The Department of Public Works level net is composed of more than 1,700 miles of levels supporting in excess of 9,000 bench marks. Previously when a major readjustment of the net was undertaken, to emphasize the complete break with previous elevations, the CY, CG, & CL, series bench marks were re-labeled DY, DG, & DL, respectively.

Beginning in 1993 the baseline readjustment year will be indicated on baseline BM,s only indicated below (*). Henceforth all BM numbers will be labeled as a Y, G, or L, series that will no longer indicate the major adjustment year.

To facilitate the adjustment, indexing and distribution of adjusted values of the net, the county territory was divided into 33 quads or areas. For the identification purposes each quad was given a name, viz., "Rosemead," "La Mirada," "Santa Fe," etc. When bench marks and elevations in these quads are used, the name must be included in the bench mark description, e.g.,

* BASELINE 295.461 L&BR IN CTR OF CB RET @ NE COR Y 9191
(1990) LA HABRA BLVD & VALLEY HOME AVE
35FT N & 35FT E/O C/L INT

It is expected that this general adjustment will for the most part remain sound for 8 to 12 years. Updating constrained adjustments will continue in the future. When a quad is readjusted, new elevations will be published and the date of readjustment will be noted in the bench mark description. Two bench marks with different adjustment dates will not normally agree with each other.

The basic accuracy of the net is reflected by an indicated field probable error of plus or minus 0.012 foot per mile of leveling as determined from the conditions of closure. However, many years of experience in vertical control in the greater Los Angeles basin and Antelope Valley indicate that because of varying degrees of subsidence and heaving, the true datum is recovered only by obtaining substantial agreement of a number of bench marks.

The users of this net are invited to assist in its maintenance by notifying this department of cases of obliteration, apparent mistakes in description or elevations, and proven disturbance of bench marks.

=====
DATUM: U.S. Coast and Geodetic Survey Sea Level Datum
of 1929, through the medium of the Los Angeles
County Engineer Precise Level Net.

ABBREVIATIONS USED IN BENCH MARK LISTINGS

ABUT -----	Abutment	ECR -----	End of Curb Return
ALG -----	Along	EC -----	End of Curve
ANG PT -----	Angle Point	ENT -----	Entrance
B/W -----	Back of Walk	FL -----	Floor
BCR -----	Beginning of Curb Return	FTG -----	Footing
BC -----	Beginning of Curve	FRWY -----	Freeway
BLDG -----	Building	F/W -----	Front of Walk
BM -----	Bench Mark	GAR -----	Garage
BT SPK -----	Boat or Bolt Spike	HDWL -----	Headwall
BR CAP -----	Brass or Bronze Cap	HSE -----	House
C B -----	Catch Basin	HWY -----	Highway
CTR -----	Center	INT -----	Intersection
C/L -----	Center Line	IP -----	Iron Pipe
C/L INT -----	Center Line Intersection	LT -----	Left
C/L PROD -----	Center Line Produced	LACE -----	L.A. City Engineer
CONC -----	Concrete	LACS -----	L.A. Co. Engineer
COR -----	Corner	LAFC -----	L.A. Co. Flood Control
COE -----	Corps of Engineers	L&BN -----	Lead and Bench Nail
CULV -----	Culvert	L&BR -----	Lead and Brad
CYN -----	Canyon	L&N -----	Lead and Nail
CB -----	Curb	L&SPK -----	Lead and Spike
CS MON -----	Co. Eng. Monument	L&T -----	Lead and Tack
CT SPK -----	Cut Spike	MCR -----	Middle of Curb Return
DPW -----	Dept. of Public Works	MKD -----	Marked
DR -----	Drive or Driveway	MC -----	Middle of Curve
E/O -----	East of	MON -----	Monument

ABBREVIATIONS USED IN BENCH MARKS (CON'T)

N/O ----- North of
NR ----- Near
OPP ----- Opposite
PI ----- Point of Intersection
PK&W ----- PK Nail and Washer
P/L ----- Property Line
POST ----- Point of Semi-Tangent
PP ----- Power Pole
PVMT ----- Pavement
PROD ----- Produced
RD ----- Road
RDBM ----- Road Dept. Bench Mark
RDBM TAG ----- Road Dept. Bench Mark Tag
RR ----- Railroad
RT ----- Right
R/W ----- Right of Way
SDMH ----- Storm Drain Manhole
SMH ----- Sewer Manhole
SPK ----- Spike
ST&W ----- Spike Tin and Washer
S/O ----- South of
TP ----- Telephone Pole
USC&GS ----- U.S. Coast and Geodetic Survey
USGS ----- U.S. Geological Survey
WK ----- Walk
W/O ----- West of

CITY OF

CITY OF SAN GABRIEL

ALHAMBRA

ROSEMEAD QUAD

RIVERA

QUAD

WHITTIER

QUAD

QUAD

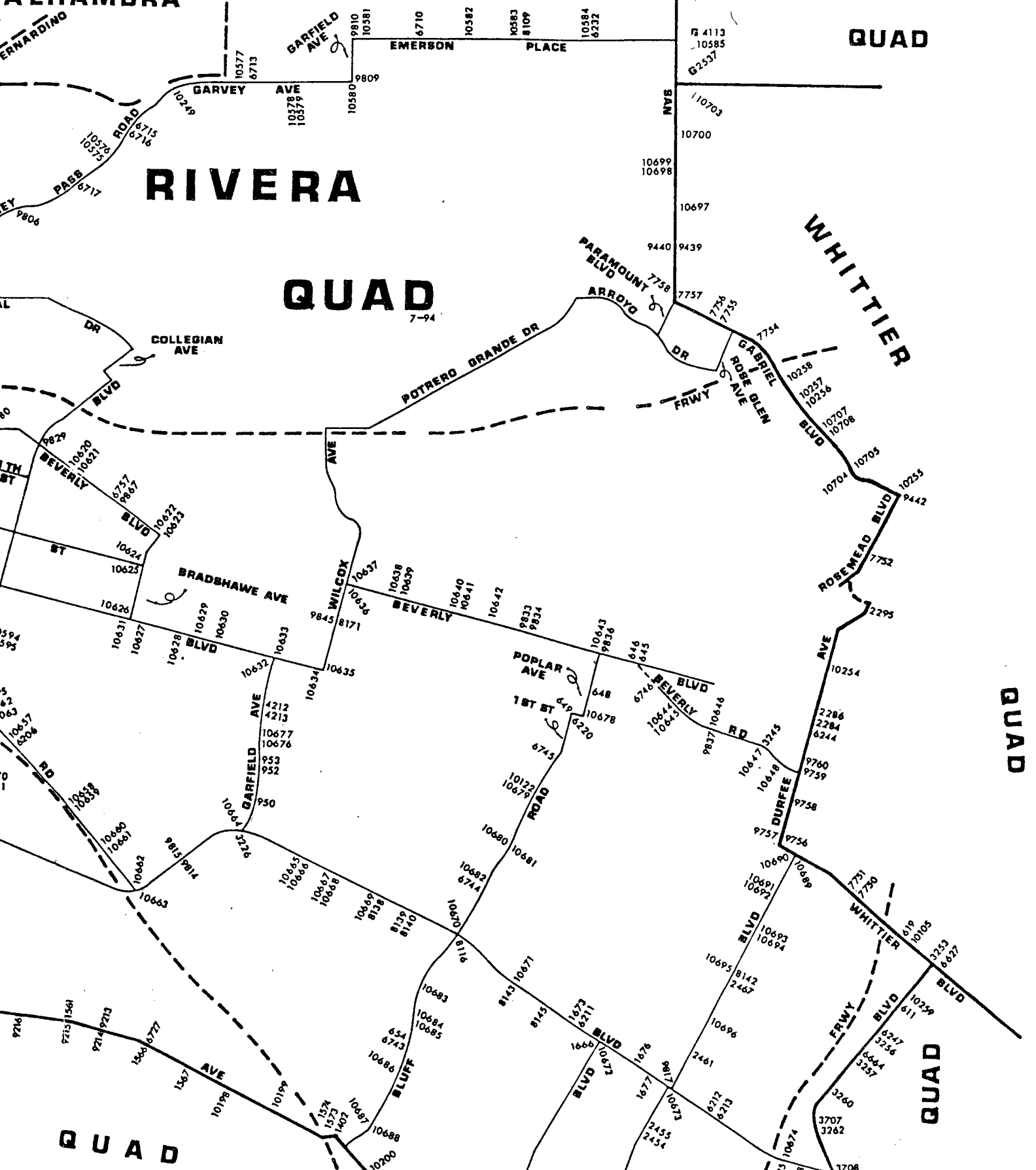

CITY ALHAMBRA
ANGELES

LOS

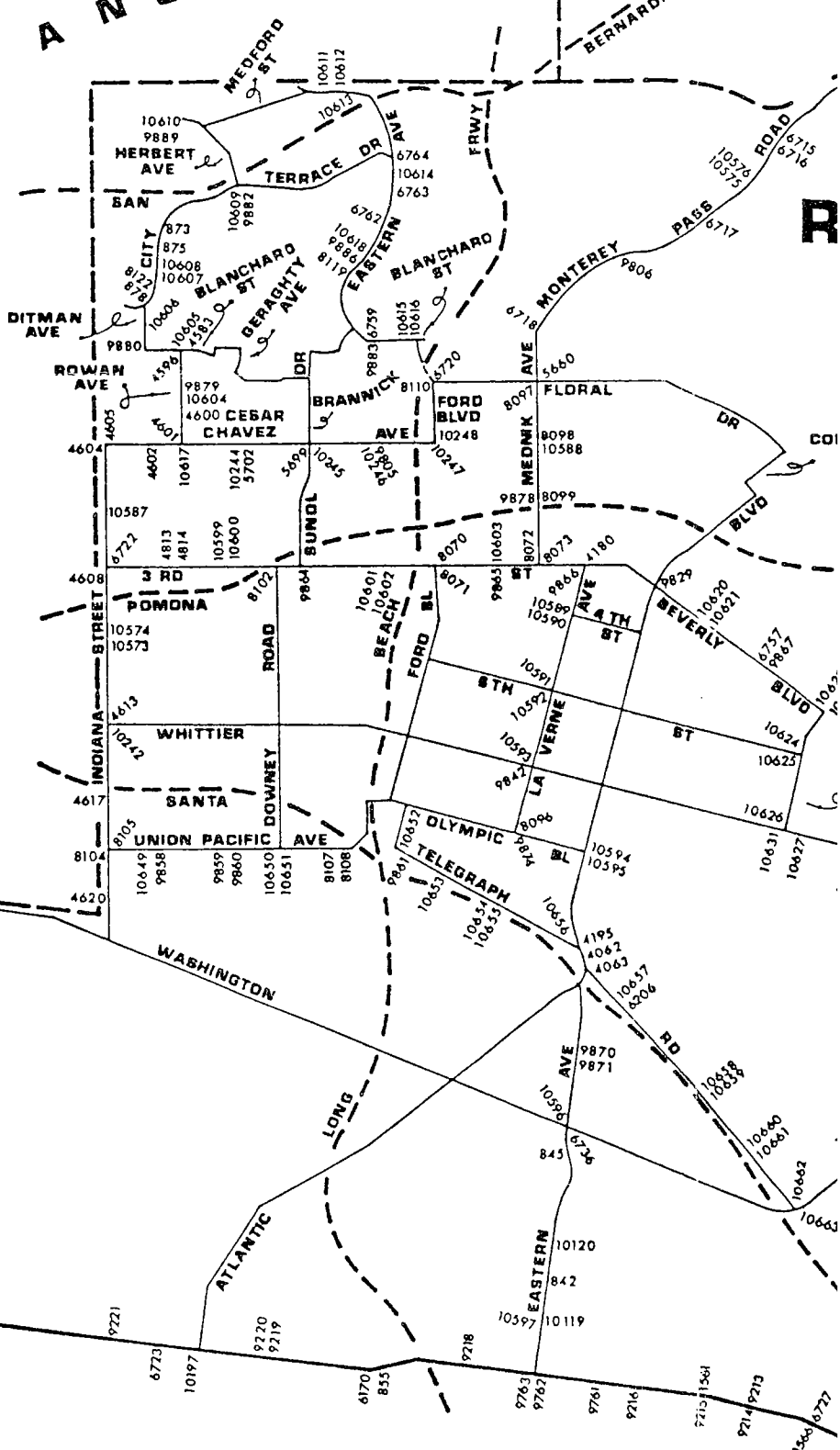

J F

TS
JAD

ALL BM NUMBERS SHOWN WITHOUT

QUA

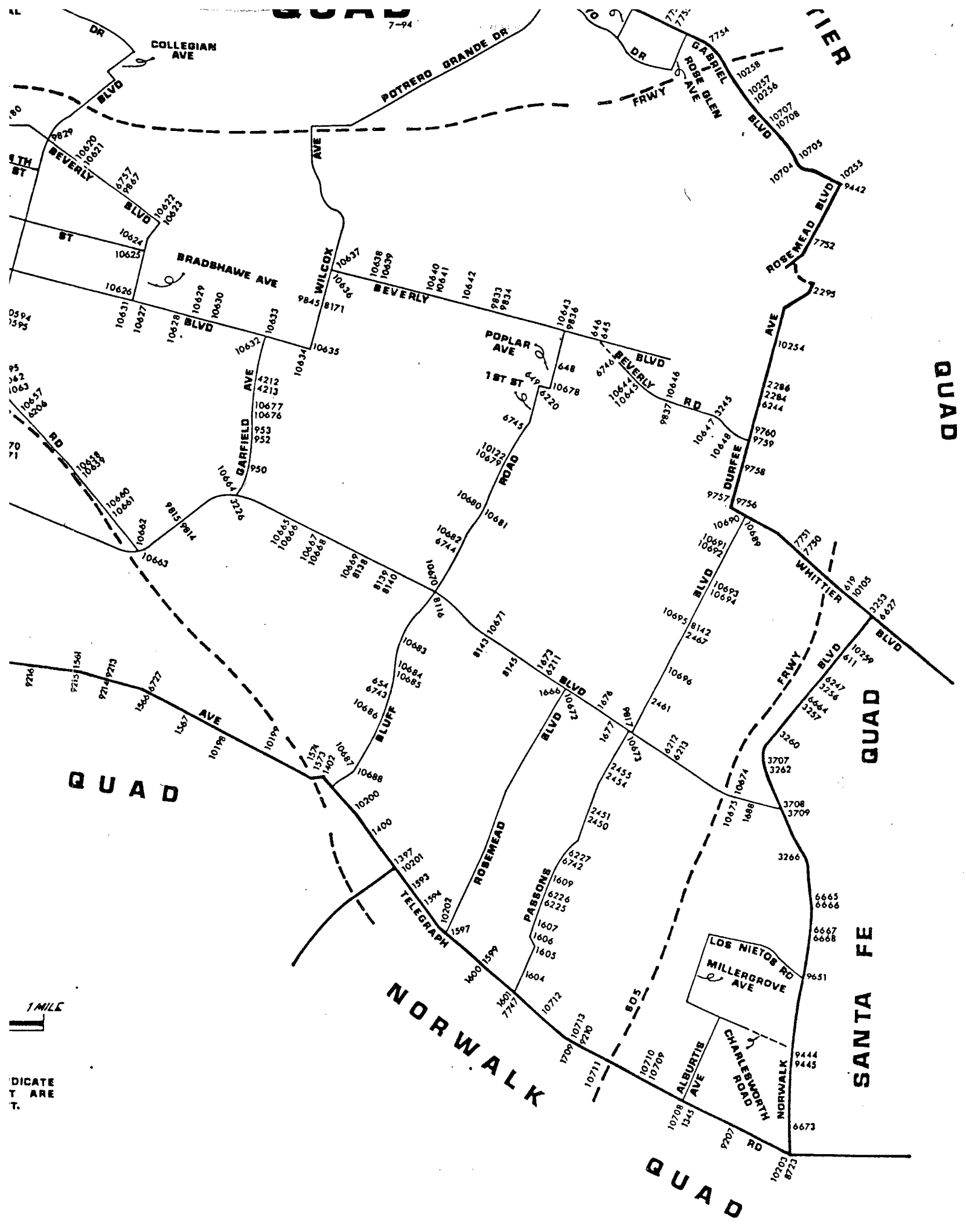

DICATE
 T ARE
 T.

O F

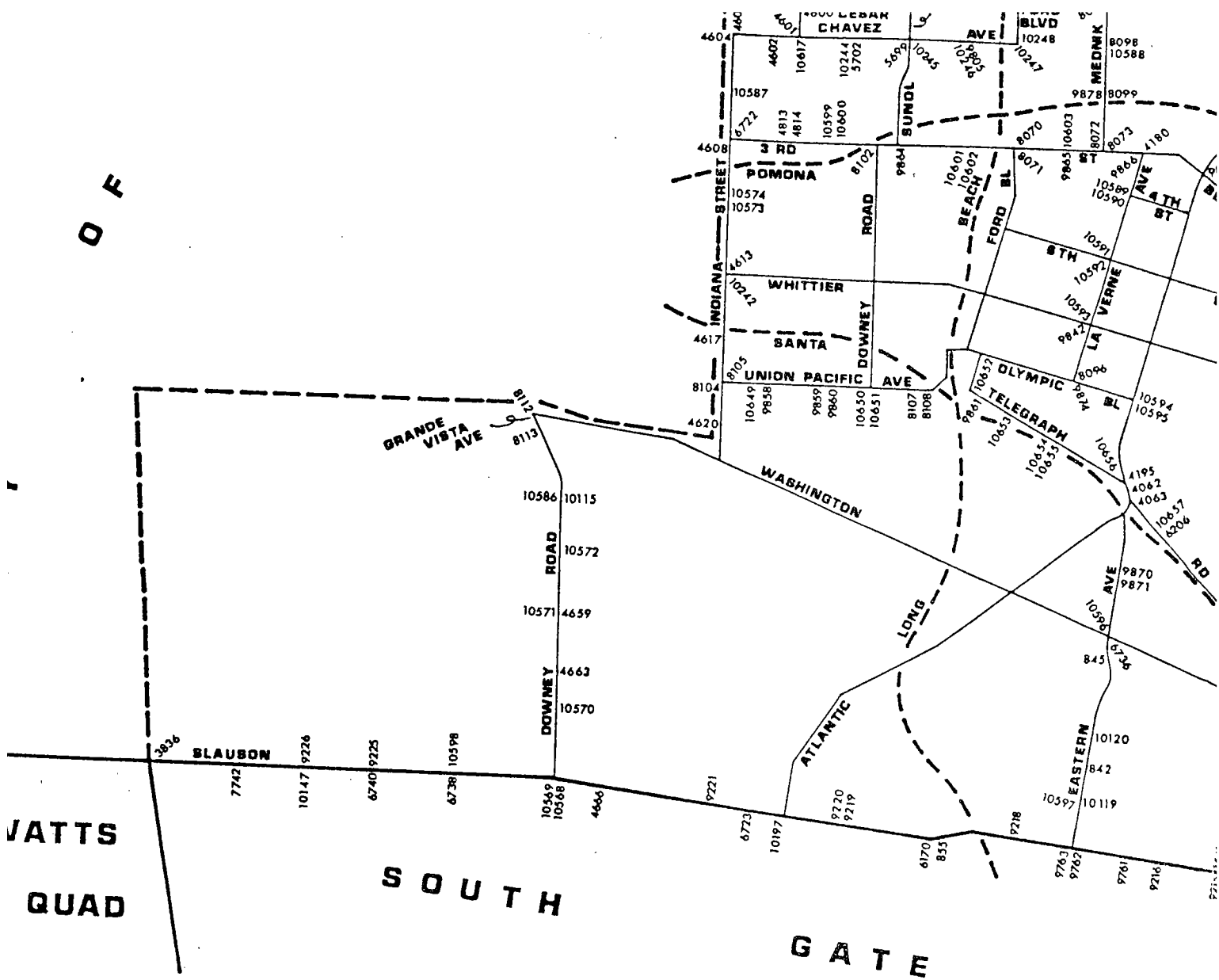

VATTS
QUAD

SOUTH
GATE

ALL BM NUMBERS SHOWN WITHOUT
A LETTER PREFIX ARE Y BM'S

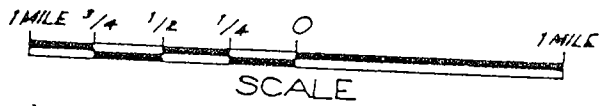
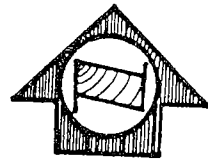

LIGHT SOLID LINES WITHOUT NUMBERS INDICATE
PREVIOUS LINES OF BENCH MARKS THAT ARE
NOT INCLUDED IN THE 1980 ADJUSTMENT.

QUAD-YEAR	ELEV	DESCRIPTION (INCLUDE QUAD AND YEAR IN DESCRIPTION)	BM NUMBER
BASELINE (1990)	0169.272	L&SPK IN CTR OF WK 3FT E/O FLAGPOLE @ WEST WHITTIER SCHOOL 51FT W C/L NORWALK BLVD & 250FT N/O C/L BEXLEY DR (TO THE W)	Y 611
BASELINE (1990)	0174.938	L&BR IN S CB WHITTIER BLVD 8FT N/O BCR 28FT S/O C/L ON C/L PROD REDMAN AVE (TO THE N)	Y 619
RIVERA (1994)	0205.033	L&BN IN E CB 1FT N/O BCR @ NE COR BEVERLY BLVD & N RD LEADING TO (GRANT REA MEMORIAL PARK) 75FT N & 20FT E/O C/L INT	Y 645A
RIVERA (1994)	0205.130	CS MON IN CB ON NOSE OF ISLAND N RD LEADING TO (GRANT REA MEMORIAL PARK) 49FT N/O N CB BEVERLY BLVD & 85FT W/O W EDGE BRIDGE #B976 MKD (BM 51-10A 1961)	Y 646A
RIVERA (1994)	0209.655	L&BR IN CB @ NW COR POPLAR AVE & MADISON AVE 34FT W & 20FT N/O C/L INT	Y 648
RIVERA (1994)	0208.362	L&BN IN CB 1FT W BCR @ NW COR WHITTIER BLVD & 1ST ST 37FT W & 28FT N/O C/L INT	Y 649
RIVERA (1994)	0172.617	L&BN IN W CB 1FT N/O C B 250FT N & 20FT W/O C/L INT BLUFF RD & SYCAMORE ST (NR HSE #1425)	Y 654
RIVERA (1994)	0137.622	L&BN IN E CB NR S END CB 15FT N/O JCT RR 38FT E C/L EASTERN AVE & 385FT S/O C/L BANDINI BLVD	Y 842
RIVERA (1994)	0138.410	L&T IN E CB 4FT S/O BCR @ SE COR EASTERN AVE & SHELIA ST 58FT S & 39FT E/O C/L INT	Y 845
BASELINE (1990)	0157.675	L&N IN W END OF N HDWL OF BRIDGE OVER LA RIVER 29FT N/O C/L SLAUSON AVE MKD (U S E D BM #2305)	Y 855
RIVERA (1994)	0399.767	RD MON IN WELL @ C/L INT CITY TERRACE DR & ROWAN AVE	Y 873A
RIVERA (1994)	0415.214	RD MON IN WELL @ C/L INT CITY TERRACE DR & RAMBOZ DR	Y 875A
RIVERA (1994)	0419.086	RD MON IN WELL P.O.S.T. DITMAN AVE & CITY TERRACE DR MKD (1950)	Y 878A
RIVERA (1994)	0171.817	L&BN IN E CB GARFIELD AVE 2FT N/O MC & 896FT S/O FLOTILLA ST @ BLDG #2100	Y 950A
RIVERA (1994)	0173.476	RD BM TAG IN CB 6FT E/O BCR @ SE COR GARFIELD AVE & FLOTILLA ST 81FT E & 30FT S/O C/L INT	Y 952A

QUAD-YEAR	ELEV	DESCRIPTION (INCLUDE QUAD AND YEAR IN DESCRIPTION)	BM NUMBER
RIVERA (1994)	0173.468	RD BM TAG 2FT N/O ANG PT @ BCR NW COR GARFIELD AVE & FLOTILLA ST 75FT N & 40FT W/O C/L INT	Y 953A
BASELINE (1990)	0131.013	RD BM TAG IN S CB 2FT W/O W END MAIN DRWY TO FIRE STA #4 @ 11736 TELEGRAPH RD 40FT S/O C/L & 390FT W/O C/L PIONEER BLVD	Y 1345A
BASELINE (1990)	0141.886	CS MON IN WELL 8IN DN ON C/L TELEGRAPH RD 20FT WLY OF PARAMOUNT BL MKD (BELL K4 1941 RE 2177)	Y 1397A
BASELINE (1990)	0143.611	RAM SET IN N CB 58FT E/O MOST ELY DRWY OF BLDG #8001 TELEGRAPH RD & 38FT N/O C/L (16FT E/O PP #14630Y)	Y 1400A
BASELINE (1990)	0151.584	L&T IN N CB TELEGRAPH RD 4FT E/O BCR @ NE COR SLAUSON AVE 40FT N & 105FT E/O C/L INT	Y 1402A
BASELINE (1990)	0139.872	L&T IN N CB SLAUSON AVE 13FT W/O W END C B @ WLY END OF CURVE 42FT N/O C/L & 300FT E/O C/L BOXFORD AVE	Y 1561
BASELINE (1990)	0148.334	L&T IN N CB 2FT E/O BCR @ NE COR SLAUSON AVE & GARFIELD AVE 65FT E & 38FT N/O C/L INT	Y 1566
BASELINE (1990)	0152.439	L&BN IN S CB SLAUSON AVE 38FT S/O C/L & 124FT W/O W END BLDG #7030 (3FT N/O PP #666256E)	Y 1567A
BASELINE (1990)	0152.028	L&T IN S CB TELEGRAPH RD 5FT E/O BCR @ SE COR COR SLAUSON AVE 40FT S & 48FT E/O C/L INT	Y 1573A
BASELINE (1990)	0156.901	RD MON IN WELL @ C/L INT SLAUSON AV & GAGE AVE MKD (LACO RD DEPT 1959)	Y 1574
BASELINE (1990)	0142.489	L&BN IN CB 4FT S/O BCR @ SW COR TELEGRAPH RD & BIRCHBARK AVE 80FT S & 18FT W/O C/L INT	Y 1593
BASELINE (1990)	0144.834	L&BN IN CB 4FT S/O BCR @ SW COR TELEGRAPH RD & STAMPS RD 78FT S & 18FT W/O C/L INT	Y 1594
BASELINE (1990)	0137.654	CS MON IN WELL @ C/L INT TELEGRAPH RD & LAKEWOOD BL MKD (TRAV STA BELL K-5A RE 2177 1941)	Y 1597A
BASELINE (1990)	0138.219	L&T IN S END OF W GAS ISL @ NE COR TELEGRAPH RD & SERAPIS AVE 67FT N & 61FT E/O C/L INT	Y 1599
BASELINE (1990)	0136.991	L&T IN S CB 6FT W/O BCR @ SE COR TELEGRAPH RD & SERAPIS AVE 50FT E & 40FT S/O C/L INT	Y 1600A
BASELINE (1990)	0140.980	L&BN @ BCR OF SERVICE RD N CB 36FT W/O C/L PASSONS BLVD & 50FT S/O C/L TELEGRAPH RD	Y 1601

QUAD-YEAR	ELEV	DESCRIPTION (INCLUDE QUAD AND YEAR IN DESCRIPTION)	BM NUMBER
RIVERA (1994)	0141.657	L&BN IN CB 1FT N/O BCR @ NE COR CLAYMORE ST & PASSONS BLVD 52FT N & 20FT E/O C/L INT	Y 1604
RIVERA (1994)	0145.895	L&BN IN CB 2FT N/O BCR @ NE COR SUNGLOW ST & BUHMAN AVE (TO THE N) 51FT N & 18FT E/O C/L INT	Y 1605
RIVERA (1994)	0146.451	L&BN IN CB 1FT N/O BCR @ ANG PT PASSONS BLVD & CHARLESWORTH DR 200FT S & 20FT E/O C/L INT @ HSE #8430	Y 1606
RIVERA (1994)	0148.048	L&BN IN CB 1FT N/O BCR @ NE COR PASSONS BLVD & LA DOCENA LN 45FT N & 45FT E/O C/L INT	Y 1607
RIVERA (1994)	0147.364	L&BN IN CB 1FT W/O BCR @ NW COR PASSONS BLVD & MYRON ST 45FT W & 18FT N/O C/L INT	Y 1609
RIVERA (1994)	0160.886	RD BM TAG IN N CB 50FT W/O BCR @ NW COR ROSE-MEAD BLVD & WASHINGTON BLVD 120FT W & 38FT N/O C/L INT	Y 1666A
RIVERA (1994)	0161.299	L&T IN W CB 2FT N/O BCR @ NW COR WASHINGTON BL & CROSSWAY DR 73FT N & 16FT W/O C/L INT	Y 1673A
RIVERA (1994)	0160.613	L&BN IN N CB 1FT E/O BCR @ NE COR WASHINGTON BLVD & LINDSEY AVE 56FT E & 38FT N/O C/L INT	Y 1676
RIVERA (1994)	0160.031	L&T IN CTR ISLAND CB RET @ SW COR KILGARRY AVE & WASHINGTON BLVD 45FT S & 28FT W/O C/L INT	Y 1677
RIVERA (1994)	0157.017	L&BN IN CB 1FT E/O BCR @ NE COR WASHINGTON BLVD & MORRILL AVE 35FT N & 51FT E/O C/L INT	Y 1688
BASELINE (1990)	0137.094	CS BR CAP MON @ PI 6.82FT E/O C/L INT TRUE AVE & TELEGRAPH RD	Y 1709
BASELINE (1990)	0186.431	L&BN IN E CB 15FT N/O BCR @ NE COR BEVERLY BL & DURFEE AVE 100FT N & 20FT E/O C/L INT	Y 2284
BASELINE (1990)	0190.806	SPK N END 1ST STEP TO HSE #4252 64FT E/O & 40FT N/O C/L INT DURFEE AVE & DORK ST	Y 2286
BASELINE (1990)	0194.733	L&T IN SW COR CONC LEG OF WATER & POWER TOWER #253D4 93FT N & 73FT E/O C/L INT DURFEE AVE & KRUSE RD	Y 2295
RIVERA (1994)	0153.579	L&BN IN W CB PASSONS BLVD 2FT N/O N EDGE DRWY TO HSE #7525 20FT W/O C/L PASSONS BLVD & 103FT S/O C/L PROD BASCOM ST	Y 2450

QUAD-YEAR	ELEV	DESCRIPTION (INCLUDE QUAD AND YEAR IN DESCRIPTION)	BM NUMBER
RIVERA (1994)	0153.942	L&T IN W CB PASSONS BLVD 1FT N/O N EDGE DRWY TO HSE #7503 20FT W/O C/L & 115FT N/O C/L PROD BASCOM ST	Y 2451
RIVERA (1994)	0156.185	L&T IN E CB 4FT S/O BCR @ SE COR PASSONS BLVD FOXBURY WAY 47FT S & 20FT E/O C/L INT	Y 2454
RIVERA (1994)	0157.014	L&T IN E CB PASSONS BLVD 1FT N/O N EDGE DRWY TO HSE #7202 30FT S/O C/L PROD DANBRIDGE ST	Y 2455
RIVERA (1994)	0163.257	L&T IN E CB 0.5FT N/O BCR @ NE COR PASSONS BLVD & CARRON DR 41FT N & 20FT E/O C/L INT	Y 2461
RIVERA (1994)	0167.162	L&T IN W CB 1FT N/O BCR @ SW COR PASSONS BLVD & COSGROVE ST 43FT S & 21FT W/O C/L INT	Y 2467
BASELINE (1990)	0275.823	FC BR CAP IN W WINGWALL 73FT N C/L GARVEY AVE & 225FT W C/L SAN GABRIEL BLVD MKD (BM 55-24)	G 2537
RIVERA (1994)	0167.447	L&BN @ MCR OF PARKING AREA 70FT S & 150FT W/O C/L INT WASHINGTON BLVD & GARFIELD AVE	Y 3226
RIVERA (1994)	0182.319	L&T IN E CB 6FT N/O BCR @ NE COR BEVERLY RD & ROSEMEAD BLVD 73FT N & 44FT E/O C/L INT	Y 3245
BASELINE (1990)	0175.592	CS BR CAP MON 3FT SW OF C/L INT NORWALK BLVD & WHITTIER BLVD (TO THE N) MKD (WHITTIER E-2 RE 329 1948)	Y 3253
BASELINE (1990)	0166.352	L&BR IN W CB 2FT S/O BCR @ NW COR ROSEHEDGE DR & NORWALK BL 54FT N & 33FT W/O C/L INT	Y 3256
BASELINE (1990)	0164.456	L&SPK IN E CB 5FT S/O BCR @ SE COR NORWALK BL & MINES BL 77FT S & 38FT E/O C/L INT	Y 3257
BASELINE (1990)	0161.798	L&BN IN E CB 1FT S/O BCR @ SE COR NORWALK BL & FLORY ST 54FT S & 38FT E/O C/L INT	Y 3260
BASELINE (1990)	0160.596	RE TAG #2059 @ BK OF WK 56FT S/O BCR @ SE COR NORWALK BL & CHOISSER ST 112FT S & 50FT E/O C/L INT	Y 3262
BASELINE (1990)	0153.705	L&BN IN CB 1FT N/O BCR @ NW COR NORWALK BL & WADDELL ST 60FT N & 38FT W/O C/L INT	Y 3266
BASELINE (1990)	0160.549	RAM SET NR CTR CB RET @ SE COR NORWALK BL & CHOISSER ST 45FT E & 29FT S/O C/L INT	Y 3707
BASELINE (1990)	0157.495	RAMSET IN W CB 3FT N/O BCR @ NW COR WASHINGTON BLVD & NORWALK BLVD 135FT N & 38FT W/O C/L INT	Y 3708

QUAD-YEAR	ELEV	DESCRIPTION (INCLUDE QUAD AND YEAR IN DESCRIPTION)	BM NUMBER
BASELINE (1990)	0157.891	CE BR CAP FL IN CB OF ISL @ NW COR WASHINGTON BLVD & NORWALK BLVD 81FT N & 32FT W/O C/L INT MKD (BM 2-14A 1961 RE 5869)	Y 3709
BASELINE (1990)	0178.957	CS MON IN C/L SLAUSON AVE 14FT W/O W RAIL SPRR & 20FT E/O C/L ALAMEDA ST MKD (WATTS H-2A 1938 RE 4233)	Y 3836
RIVERA (1994)	0149.299	L&BN IN N CB TELEGRAPH RD 30FT N & 125 FT E/O C/L INT TELEGRAPH RD & ATLANTIC BLVD	Y 4062
RIVERA (1994)	0149.447	L&BN IN S CB TELEGRAPH RD 30FT S & 175FT E/O C/L INT TELEGRAPH RD & ATLANTIC BLVD	Y 4063
BASELINE (1990)	0279.777	CS BM MON IN WELL 1FT N/O CB @ BCR NW COR SAN GABRIEL BLVD & EMERSON PL 59FT W & 19FT N/O C/L MKD (BM 1-25C 1970 RE 5869)	G 4113
RIVERA (1994)	0262.518	L&BN IN N CB 3RD ST 40FT N/O C/L & 11FT W/O C/L PROD LA VERNE AVE	Y 4180
RIVERA (1994)	0154.372	MOST WLY CUT SPK NR CTR CB RET @ NW COR ATLANTIC BLVD & TELEGRAPH RD 54FT N & 69FT W/O C/L INT	Y 4195
RIVERA (1994)	0193.830	L&BN IN N CB 35FT E/O BCR @ NE COR OLYMPIC BLVD & GARFIELD AVE 115FT E & 36FT N/O C/L INT	Y 4212
RIVERA (1994)	0190.906	L&T IN CB 5FT W/O BCR @ NW COR GARFIELD AVE & FAIRFIELD ST 80FT W & 20FT N/O C/L INT	Y 4213
RIVERA (1994)	0418.008	L&T IN CONC RET WALL 30FT E & 27FT S/O C/L INT BLANCHARD ST & ROWAN AVE MKD (BM)	Y 4583
RIVERA (1994)	0414.322	L&BR IN CONC WK @ NW COR ROWAN AVE & WINTER ST 30FT N & 30FT W/O C/L INT (@ HSE #3547)	Y 4596
RIVERA (1994)	0308.080	L&T IN W CB 20FT W/O C/L ROWAN AVE @ C/L PROD DOZER ST	Y 4600
RIVERA (1994)	0300.144	L&BN IN W CB 1FT S/O BCR @ SW COR ROWAN AVE & CESAR E CHAVEZ AVE 40FT S & 20FT W/O C/L INT	Y 4601
RIVERA (1994)	0297.922	L&BN IN E CB 7FT N/O BCR @ NE COR DITMAN AVE & CESAR E CHAVEZ AVE 53FT N & 20FT E/O C/L INT MKD (BM)	Y 4602
RIVERA (1994)	0290.033	CUT SPK IN E CB INDIANA ST N END C B 20FT S/O C/L PROD BROOKLYN PL	Y 4604

QUAD-YEAR	ELEV	DESCRIPTION (INCLUDE QUAD AND YEAR IN DESCRIPTION)	BM NUMBER
RIVERA (1994)	0289.501	LACE HEX BAR MON @ C/L INT BROOKLYN PL & INDIANA ST	Y 4605
RIVERA (1994)	0316.825	CUT SPK IN S CB 5FT W/O BCR @ SW COR INDIANA ST & 3RD ST 53FT W & 37FT S/O C/L INT	Y 4608
RIVERA (1994)	0222.663	CUT SPK IN N CB 7FT W/O BCR W END C B @ NW COR INDIANA ST & WHITTIER BLVD 123FT W & 30FT N/O C/L INT	Y 4613
RIVERA (1994)	0187.362	WIRE SPK IN N CB 5FT W/O BCR @ NW COR INDIANA ST & OLYMPIC BLVD 45FT W & 37FT N/O C/L INT (E END C B)	Y 4617
RIVERA (1994)	0179.432	CS BR CAP MON IN WELL 17FT E & 11FT N/O APPROX C/L INDIANA ST & NOAKES ST MKD (ALHAMBRA B-11 RE 2177)	Y 4620
RIVERA (1994)	0182.143	L&SQ BOLT IN N CB @ NW COR DOWNEY RD & LEONIS BLVD 76FT W & 28FT N/O C/L INT	Y 4659
RIVERA (1994)	0179.872	SQ HD SPK IN NW COR CONC SLAB @ SE COR DOWNEY RD & FRUITLAND AVE & 35FT S & 35FT E/O C/L INT	Y 4663
BASELINE (1990)	0162.162	CS MON IN WELL 8IN DN 2FT S & 4FT W/O C/L INT SLAUSON AVE & EVERETT AVE MKD (WATTS TRAV STA L-2B RE 4233 1938)	Y 4666
RIVERA (1994)	0311.961	L&T IN W CB 8FT S/O BCR @ SW COR 3RD ST & ROWAN AVE 75FT S & 20FT W/O C/L INT	Y 4813
RIVERA (1994)	0312.031	L&T IN E CB 11FT S/O BCR @ SE COR ROWAN AVE & 3RD ST 75FT S & 20FT E/O C/L INT	Y 4814
RIVERA (1994)	0309.719	L&BN IN E CB 34FT N/O BCR @ NE COR FLORAL DR & MENDIK AVE 87FT N & 35FT E/O C/L INT	Y 5660
RIVERA (1994)	0270.164	SQ HD SPK IN N CB @ NW COR CESAR E CHAVEZ AVE & CARMELITA AVE 191FT W & 30FT N/O C/L INT	Y 5699
RIVERA (1994)	0312.256	L&T IN N CB 2FT E/O BCR @ NE COR RECORD AVE & CESAR E CHAVEZ AVE 38FT E & 28FT N/O C/L INT	Y 5702
BASELINE (1990)	0139.471	CS BR CAP MON IN WELL 12IN DN @ NE COR SLAUSON AVE & ALAMO AVE 57FT N & 41FT E/O C/L INT MKD (BM 4-21 1951 RE 329)	Y 6170
RIVERA (1994)	0146.977	L&T SLY CB TELEGRAPH RD 40FT SLY C/L & 15FT ELY C/L PROD HOFNER AVE (NR WLY END C B)	Y 6206

QUAD-YEAR	ELEV	DESCRIPTION (INCLUDE QUAD AND YEAR IN DESCRIPTION)	BM NUMBER
RIVERA (1994)	0161.383	L&T IN CB 1FT W/O BCR @ NE COR WASHINGTON BLVD & CROSSWAY DR 54FT E & 38FT N/O C/L INT	Y 6211
RIVERA (1994)	0155.683	L&T IN N CB (SERV RD) 25FT W/O BCR @ NW COR WASHINGTON BLVD & PICO VISTA RD 78FT N & 50FT W/O C/L INT	Y 6212
RIVERA (1994)	0156.655	L&T IN N CB @ NE COR WASHINGTON BLVD & PICO VISTA RD 55FT E & 38FT N/O C/L INT	Y 6213
RIVERA (1994)	0204.746	RD BM TAG IN N CB 1FT E/O BCR @ NE COR WHITTIER BLVD & 1ST ST 45FT E & 28FT N/O C/L INT	Y 6220
RIVERA (1994)	0148.567	L&BN IN W CB 7FT S/O ANG PT OF CB 43FT S/O C/L PROD SHADE LN (TO THE E) & 30FT W/O C/L INT PASSONS BLVD	Y 6225
RIVERA (1994)	0148.245	L&BN IN N CB 1FT E/O BCR @ NE COR PASSONS BLVD & SHADE LN 46FT E & 18FT N/O C/L INT MKD (BM)	Y 6226
RIVERA (1994)	0150.520	L&T IN N CB 1FT W/O BCR @ NE COR PASSONS BLVD & SLAUSON AVE 62FT E & 40FT N/O C/L INT	Y 6227
RIVERA (1994)	0302.056	CS BR CAP MON IN WELL @ C/L INT EMERSON PL & WILSON WAY MKD (RE)	Y 6232
BASELINE (1990)	0185.340	RD MON IN WELL @ C/L INT DURFEE AVE & BEVERLY BLVD & BEVERLY BLVD	Y 6244
BASELINE (1990)	0166.395	CO ENGR BR CAP IN NLY END C B 79FT N & 37FT W/O C/L INT ROSEHEDGE DR & NORWALK BL MKD (BM 2-16 1961 RE 5869)	Y 6247
BASELINE (1990)	0177.259	RD BM TAG IN W CB 37FT N/O BCR @ NW COR NORWALK BL & WHITTIER BL 105FT N & 29FT W/O C/L INT	Y 6627
BASELINE (1990)	0164.618	SPK IN S CB 7FT E/O BCR @ SE COR NORWALK BL & MINES BL 84FT E & 38FT S/O C/L INT	Y 6664
BASELINE (1990)	0151.778	BT SPK IN W CB 8FT N/O BCR @ NW COR NORWALK BL & SLAUSON AVE 86FT N & 40FT W/O C/L INT	Y 6665
BASELINE (1990)	0151.685	RD BM TAG IN E CB 2FT N/O BCR @ SE COR NORWALK BL & SLAUSON AVE 82FT S & 40FT E/O C/L INT	Y 6666
BASELINE (1990)	0152.938	L&T IN E CB NORWALK BL 40FT E/O C/L ON C/L PROD BURKE ST	Y 6667
BASELINE (1990)	0153.035	RD BM TAG IN E CB 2FT S/O BCR @ SE COR NORWALK BL & BURKE ST 40FT E & 35FT S/O C/L INT	Y 6668

QUAD-YEAR	ELEV	DESCRIPTION (INCLUDE QUAD AND YEAR IN DESCRIPTION)	BM NUMBER
BASELINE (1990)	0147.005	L&T IN CONC CB OF PLANTER 50FT E/O C/L NORWALK BL & 151FT N/O C/L DRWY ENT TO BLDG #10132 (0.2MI N/O TELEGRAPH RD)	Y 6673
RIVERA (1994)	0380.984	CSBM MON IN WELL @ SE COR EMERSON AVE & ALHAMBRA AVE 31FT S & 29FT E/O C/L INT MKD (BM 31-19 RE 63 1953) 4FT E/O E CB	Y 6710
RIVERA (1994)	0379.675	CSBM MON IN WELL @ SE COR GARVEY AVE & ATLANTIC BLVD 177FT E & 40FT S/O C/L INT 1FT S/O S CB MKD (BM 31-17 1953 RE 63)	Y 6713
RIVERA (1994)	0414.916	L&BN IN SLY END OF CONC PLANTER WLY TRAFFIC ISL 36FT W/O C/L MONTEREY PASS RD @ FREMONT AVE OPP FROM N SIDE PROD BLDG #508	Y 6715
RIVERA (1994)	0412.336	L&BR IN W CB MONTEREY PASS RD 35FT W/O C/L 80FT S/O BCR @ FREMONT AVE NR S SIDE PROD BLDG #509	Y 6716
RIVERA (1994)	0398.945	CS BM MON FL IN C B 1FT E/O E CB 35FT E/O C/L MONTEREY PASS RD 0.5MI S/O FREMONT AVE NR N SIDE PROD BLDG #736 MKD (BM 31-15A 1961 RE 5869)	Y 6717
RIVERA (1994)	0334.360	L&BR IN E CB MONTEREY PASS RD 35FT E & 33FT S/O B C 125FT N/O PI MONTEREY PASS RD & KERN AVE C/L @ BLDG #1350 (20FT NLY OF SLY P/L)	Y 6718
RIVERA (1994)	0312.352	CS BM MON IN WELL @ NW COR FORD BLVD & FLORAL DR 71FT N & 19FT W/O C/L INT MKD (31-12A 1961 RE 5869)	Y 6720
RIVERA (1994)	0316.803	L&T IN N CB 9FT E/O BCR @ NE COR INDIANA ST & 3RD ST 40FT N & 59FT E/O C/L INT	Y 6722
BASELINE (1990)	0150.751	CS MON IN WELL 10IN DN @ SLAUSON AV & FLORA AV 11FT E & 3FT N/O C/L INT MKD (BELL 2-A 1938 RE 4233)	Y 6723
BASELINE (1990)	0148.091	L&BN IN CB 1FT N/O BCR @ NW COR SLAUSON AVE & GARFIELD AVE 66FT N & 38FT W/O C/L INT	Y 6727
RIVERA (1994)	0139.165	L&T IN CB RET 20FT W/O BCR @ SE COR EASTERN AVE WASHINGTON BLVD 80FT E & 39FT S/O C/L INT	Y 6736
BASELINE (1990)	0165.222	CS MON IN WELL 15IN DN ON C/L STATE ST (BOYLE AVE TO THE N) 16FT S/O C/L SLAUSON AVE MKD (WATTS TRAV STA K-2A 1938 RE 4233)	Y 6738

QUAD-YEAR	ELEV	DESCRIPTION (INCLUDE QUAD AND YEAR IN DESCRIPTION)	BM NUMBER
BASELINE (1990)	0173.279	CS MON IN WELL 10IN DN ON C/L MILES AV (SOTO ST TO THE N) 14FT S/O C/L SLAUSON AV MKD (WATTS TRAV STA J-2E 1938 RE 4233)	Y 6740
RIVERA (1994)	0150.564	L&BN IN CB 2FT S/O BCR @ SW COR PASSONS BLVD & SLAUSON AVE 50FT S & 32FT W/O C/L INT MKD (BM)	Y 6742
RIVERA (1994)	0173.222	RD BM TAG IN W CB 1FT N/O BCR @ NW COR BLUFF RD & SYCAMORE AVE 62FT N & 20FT W/O C/L INT	Y 6743
RIVERA (1994)	0199.644	RAMSET IN CB 1FT S/O BCR OF S DRWY TO HSE #833 BLUFF RD & 0.1MI S/O BEACH ST	Y 6744
RIVERA (1994)	0211.316	L&BN IN CB 1FT S/O BCR @ SW COR LOS ANGELES AVE & BLUFF RD 53FT S & 20FT W/O C/L INT MKD (BM)	Y 6745
RIVERA (1994)	0175.984	L&BN IN S CB 1FT E/O BC OF CUL DE SAC 77FT E & 40FT S/O C/L INT BEVERLY RD & CULP DR	Y 6746
RIVERA (1994)	0245.782	L&BN IN CB 32FT S/O BCR @ SW COR BEVERLY BLVD & GERHART AVE 107FT S & 32FT W/O C/L INT	Y 6757
RIVERA (1994)	0326.641	CS BR CAP MON 10IN DN 60FT N & 35FT E/O C/L INT EASTERN AVE & E BLANCHARD ST (20FT N/O BCR) MKD (BM 61-2 RE 5869 1961)	Y 6759
RIVERA (1994)	0485.781	BT SPK IN E CB 1FT S/O BCR @ SE COR EASTERN AVE & E HAUCK ST 32FT E & 5FT S/O C/L INT	Y 6762
RIVERA (1994)	0502.402	BT SPK IN E CB @ NE COR EASTERN AVE & ROSILYN DR 32FT N & 32FT E/O C/L INT	Y 6763
RIVERA (1994)	0455.550	BT SPK IN E CB 17FT N/O BCR @ NE COR EASTERN AVE & E CITY TERRACE DR 70FT NLY & 32FT ELY OF C/L INT (3FT S/O NLY P/L TO HSE #1454)	Y 6764
BASELINE (1990)	0178.148	RD BM TAG IN CB 38FT S/O BCR @ SW COR SLAUSON AVE & SANTA FE AVE 104FT S & 36FT W/O C/L INT	Y 7742
BASELINE (1990)	0140.474	LACS MON IN SE COR C B 122FT N & 21FT W C/L INT TELEGRAPH RD & PASSONS BLVD MKD (BM 4-15A 1968)	Y 7747
BASELINE (1990)	0181.094	FC MON FL @ NE COR BRIDGE OVER SAN GABRIEL RIV 50FT N/O C/L WHITTIER BLVD MKD (BM 078-00010 1968)	Y 7750
BASELINE (1990)	0182.165	FC MON FL @ SW COR BRIDGE OVER SAN GABRIEL RIV 46FT S/O C/L WHITTIER BLVD MKD (BM 077-02855 1968)	Y 7751

QUAD-YEAR	ELEV	DESCRIPTION (INCLUDE QUAD AND YEAR IN DESCRIPTION)	BM NUMBER
BASELINE (1990)	0215.736	CO ENG BR CAP FL @ SE COR BRIDGE OVER WHITTIER NARROWS RIV 42FT E/O C/L ROSEMEAD BLVD & 0.4MI S/O SAN GABRIEL BL MKD (BM 1-20B 1965 RE 5869)	Y 7752
BASELINE (1990)	0308.235	RD BM TAG IN CB 1FT E/O BCR @ NW COR SAN GABRIEL BL & WALNUT GROVE AVE 78FT W & 42FT N/O C/L INT	Y 7754
BASELINE (1990)	0315.596	RD BM TAG IN CB 2FT ELY OF BCR 42FT NLY & 20FT ELY OF C/L INT SAN GABRIEL BLVD & DELTA ST	Y 7755
BASELINE (1990)	0317.744	RD BM TAG IN CB 2FT WLY OF BCR @ NWLY COR DELTA ST & SAN GABRIEL BLVD 42FT N & 87FT WLY C/L INT	Y 7756
BASELINE (1990)	0333.458	RD BM TAG IN CB 1FT W/O BCR @ SW COR HILL DR & SAN GABRIEL BLVD 64FT W & 42FT S/O C/L INT	Y 7757
BASELINE (1990)	0332.481	RD BM TAG IN CB 1FT W/O BCR @ NW COR HILL DR & SAN GABRIEL BLVD 115FT W & 42FT N/O C/L INT	Y 7758
RIVERA (1994)	0294.573	RD BM TAG IN CB 25FT W/O BCR @ SW COR 3RD ST & FORD BLVD 100FT W & 40FT S/O C/L INT	Y 8070
RIVERA (1994)	0295.196	RD BM TAG IN N CB 18FT W/O BCR @ NW COR 3RD ST & FORD BLVD 100FT W & 41FT N/O C/L INT	Y 8071
RIVERA (1994)	0279.964	CS MON IN N CB FL 1.5FT BK OF CF @ NE COR 3RD ST & KERN AVE 41FT N & 40FT E/O C/L INT MKD (BM 51-1 1957 RE 5869)	Y 8072
RIVERA (1994)	0281.881	L&T IN CB 14FT E/O BCR @ SE COR MEDNIK AVE & THIRD ST 70FT E & 40FT S/O C/L INT	Y 8073
RIVERA (1994)	0176.609	L&BN IN CONC APRON @ NE COR LA VERNE AVE & OLYMPIC BLVD 61FT N & 30FT E/O C/L INT	Y 8096
RIVERA (1994)	0308.221	L&T IN W CB 0.4FT S/O BCR @ SW COR FLORAL DR & MEDNIK AVE 65FT S & 40FT W/O C/L INT	Y 8097
RIVERA (1994)	0299.811	RD BM TAG IN CB 1FT N/O BCR @ NE COR MEDNIK AVE & CESAR E CHAVEZ AVE 55FT N & 32FT E/O C/L INT	Y 8098
RIVERA (1994)	0294.865	L&BN 5FT S/O BCR @ NE COR BRIDGE #B53-1734 55FT S & 30FT E/O C/L INT MENDIK AVE & 1ST ST	Y 8099
RIVERA (1994)	0242.751	L&N IN CB 22FT W BCR @ SW COR 3RD ST & DOWNEY RD 75FT W & 40FT S/O C/L INT	Y 8102
RIVERA (1994)	0183.261	WIRE SPK IN S CB 1FT W/O BCR @ SW COR INDIANA ST & UNION PACIFIC AVE 42FT W & 25FT S/O C/L INT	Y 8104

QUAD-YEAR	ELEV	DESCRIPTION (INCLUDE QUAD AND YEAR IN DESCRIPTION)	BM NUMBER
RIVERA (1994)	0183.666	WIRE SPK @ BCR N CB 20FT N & 43FT E/O C/L INT INDIANA ST & UNION PACIFIC AVE @ W END CB	Y 8105
RIVERA (1994)	0180.211	L&T 0.5FT S/O BCR @ SW COR UNION PACIFIC AVE & & MARIANNA AVE 37FT S & 20FT W/O C/L INT	Y 8107
RIVERA (1994)	0180.422	RD BM TAG IN CB 2FT E/O BCR @ NE COR MARIANNA AV & UNION PACIFIC AV 40FT E & 20FT N/O C/L INT	Y 8108
RIVERA (1994)	0349.324	RND HD SPK IN CB 18FT S/O C/L EMERSON PL & 14FT W/O C/L PROD STEVENS AVE	Y 8109
RIVERA (1994)	0313.949	L&T IN S CB 1FT E/O BCR @ SE COR FORD BLVD & FLORAL DR 36FT E & 32FT S/O C/L INT	Y 8110
RIVERA (1994)	0190.282	WIRE SPK&L 17FT N/O BCR 71FT N & 41FT E/O C/L INT WASHINGTON BLVD & GRANDE VISTA AVE	Y 8112
RIVERA (1994)	0190.724	L&SPK 12FT W/O BCR IN C B @ SW COR WASHINGTON BL & GRANDE VISTA AVE 40FT S & 40FT W/O C/L INT	Y 8113
RIVERA (1994)	0187.453	L&T IN CB 19FT E/O BCR @ SE COR WASHINGTON BLVD & BLUFF RD 76FT E & 40FT S/O C/L INT	Y 8116
RIVERA (1994)	0404.934	RD BM TAG IN E CB 545FT S/O BCR 606FT S & 32FT E/O C/L INT EASTERN AVE & SHERIFF RD	Y 8119
RIVERA (1994)	0422.913	LACS MON IN WELL P.O.S.T. TOWNSEND AVE & CITY TERRACE DR	Y 8122
RIVERA (1994)	0185.423	RD BM TAG IN CB 2FT N/O BCR @ NE COR GREENWOOD AVE & WASHINGTON BLVD 78FT N & 28FT E/O C/L INT	Y 8138
RIVERA (1994)	0189.841	RD BM TAG IN CB 3FT W/O BCR @ SW COR WASHINGTON BLVD & MONTEBELLO BLVD 52FT W & 42FT S/O C/L INT	Y 8139
RIVERA (1994)	0190.614	RDBM TAG IN CB 0.5FT W/O BCR @ SE COR WASHINGTON BLVD & MONTEBELLO BLVD 48FT E & 42FT S/O C/L INT	Y 8140
RIVERA (1994)	0167.863	L&T IN CB 2FT S/O BCR @ SW COR PASSONS BLVD & MINES AVE 75FT S & 20FT W/O C/L INT	Y 8142
RIVERA (1994)	0160.956	RD BM TAG IN CB 2FT S/O BCR @ SW COR WASHINGTON BLVD & PARAMOUNT BLVD 79FT S & 46FT W/O C/L INT	Y 8143
RIVERA (1994)	0161.154	L&T IN CB 43FT S/O C/L WASHINGTON BLVD & 43FT W/O C/L PROD CANDACE AVE	Y 8145
RIVERA (1994)	0216.716	L&BR IN CB @ BCR NE COR WILCOX AVE & MADISON AVE 34FT N & 25FT E/O C/L INT	Y 8171

QUAD-YEAR	ELEV	DESCRIPTION (INCLUDE QUAD AND YEAR IN DESCRIPTION)	BM NUMBER
BASELINE (1990)	0140.608	CS MON IN WELL 21FT S/O BCR @ SW COR NORWALK BLVD & TELEGRAPH RD 79FT S & 40FT W/O C/L INT MKD (BM 2-11B 1970 RE 5869) 1FT W/O CF	Y 8723
BASELINE (1990)	0124.536	RD BM TAG IN CB 40FT N/O C/L TELEGRAPH RD & 0.2 MI E/O PIONEER AVE 47FT W/O CTR OF RR BRIDGE # B 1201 (1952)	Y 9207
BASELINE (1990)	0144.280	FC MON FL @ NW COR BRIDGE MKD 1937 OVER SAN GABRIEL RIVER 27FT N/O C/L TELEGRAPH RD MKD (77-73 1952)	Y 9210
BASELINE (1990)	0144.392	CE MON FL IN E END C B 21FT E/O BCR @ NE COR SLAUSON AV & MALT AV 86FT E & 41FT N/O C/L INT	Y 9213
BASELINE (1990)	0143.998	RD BM TAG IN CB 3FT W/O BCR @ NW COR SLAUSON AVE & MALT AVE 52FT W & 40FT N/O C/L INT	Y 9214
BASELINE (1990)	0138.482	SPK IN N CB 5FT W/O BCR @ NW COR SLAUSON AVE & BOXFORD AVE 70FT W & 40FT N/O C/L INT	Y 9215
BASELINE (1990)	0135.544	CS BM MON FL @ BK OF CB 74FT W/O BCR @ NW COR SLAUSON AVE & ZAMBRANO ST 135FT W & 40FT N/O C/L INT MKD (BM 4-19B 1968 RE 5869) E END C B	Y 9216
BASELINE (1990)	0139.574	CS BR CAP MON 1IN UP @ BK OF WK ON W P/L LINE BLDG #5500 & 50FT S/O C/L SLAUSON AVE NR PP # 1007282H MKD (RE 329)	Y 9218
BASELINE (1990)	0142.900	RD BM TAG IN CB 2FT E/O BCR @ NE COR SLAUSON AVE & HELIOTROPE AVE 36FT N & 37FT E/O C/L INT	Y 9219
BASELINE (1990)	0143.028	RD BM TAG IN CB 2FT W/O BCR @ NW COR SLAUSON AVE & HELIOTROPE AVE 36FT N & 37FT W/O C/L INT	Y 9220
BASELINE (1990)	0156.795	RD BM TAG IN CB 2FT E/O BCR @ NE COR SLAUSON AVE & GIFFORD AVE 33FT E & 35FT N/O C/L INT	Y 9221
BASELINE (1990)	0173.755	RD BM TAG IN CB 2FT E/O BCR @ NE COR SLAUSON AVE & SOTO ST 65FT E & 35FT N/O C/L INT	Y 9225
BASELINE (1990)	0176.899	CS MON IN WELL DN 10IN ON C/L SLAUSON AVE 15FT W/O C/L PACIFIC AVE MKD (WATTS TRAV STA J-2B 1938 RE 4233)	Y 9226
BASELINE (1990)	0321.064	RD BM TAG E CB 1FT N/O BCR @ NE COR SAN GABRIEL BLVD & BLEEKER ST 42FT E & 41FT N/O C/L INT	Y 9439

QUAD-YEAR	ELEV	DESCRIPTION (INCLUDE QUAD AND YEAR IN DESCRIPTION)	BM NUMBER
BASELINE (1990)	0322.327	CE BM MON IN WELL 1FT W/O CF & 2FT S/O BCR @ SW COR SAN GABRIEL BLVD & BLEWETT ST 43FT W & 43FT S/O C/L INT MKD (BM 1-24C 1970 RE 5869)	Y 9440
BASELINE (1990)	0209.991	RD BM TAG IN S CB 1FT E/O BCR @ SE COR ROSEMEAD BL & SAN GABRIEL BL 85FT E & 42FT S/O C/L INT	Y 9442
BASELINE (1990)	0152.199	RD BM TAG IN W CB 40FT W/O C/L NORWALK BL & 529 FT S/O C/L PACIFIC ST N END OF MOST NLY DRWY TO BLDG #9703 14FT S/O LT STD #A-436	Y 9444
BASELINE (1990)	0152.014	RD BM TAG IN E CB NORWALK BLVD 40FT E/O C/L & 625FT S/O C/L PACIFIC ST @ S END OF C B 29FT S/O LT STD #A-437	Y 9445
BASELINE (1990)	0155.866	L&BR IN CB 3FT E/O BCR @ NW COR NORWALK BL & LOS NIETOS RD 93FT W & 32FT N/O C/L INT	Y 9651
BASELINE (1990)	0177.844	RD BM TAG IN C B 28FT N/O BCR @ NW COR DURFEE AVE & WHITTIER BL 91FT N & 28FT W/O C/L INT	Y 9757
BASELINE (1990)	0180.298	RD BM TAG IN C B @ NE COR DURFEE AVE & STEPHENS ST 76FT N & 28FT E/O C/L INT	Y 9758
BASELINE (1990)	0182.356	RD BM TAG IN CB 1FT S/O BCR @ SE COR BEVERLY RD & DURFEE AVE 73FT S & 31FT E/O C/L INT	Y 9759
BASELINE (1990)	0182.525	RD BM TAG IN C B 4FT E/O BCR @ NE COR BEVERLY RD & DURFEE AVE 83FT E & 35FT N/O C/L INT	Y 9760
BASELINE (1990)	0132.761	RD BM TAG IN E END C B @ NE COR SLAUSON AVE & ALEXANDER ST 145FT E & 40FT N/O C/L INT	Y 9761
BASELINE (1990)	0134.983	RD BM TAG IN S END C B @ NE COR EASTERN AVE & SLAUSON AVE 84FT N & 43FT E/O C/L INT	Y 9762
BASELINE (1990)	0135.362	RD BM TAG IN E END C B 15FT W/O BCR @ SW COR EASTERN AVE & SLAUSON AVE 96FT W & 38FT S/O C/L INT	Y 9763
RIVERA (1994)	0293.512	RD BM TAG S CB 3FT W/O BCR @ SW COR EASTERN AVE & CESAR E CHAVEZ AVE 70FT W & 28FT S/O C/L INT	Y 9805
RIVERA (1994)	0381.327	RD BM TAG IN S CB MONTEREY PASS RD 35FT S/O C/L & 0.3MI ELY OF INT KERN AVE @ BEG OF WK TO ENT ELY END OF BLDG #1000	Y 9806
RIVERA (1994)	0380.803	RD BM TAG IN E CB S END C B @ NE COR GARVEY AVE & GARFIELD AVE 59FT N & 30FT E/O C/L INT	Y 9809

QUAD-YEAR	ELEV	DESCRIPTION (INCLUDE QUAD AND YEAR IN DESCRIPTION)	BM NUMBER
RIVERA (1994)	0388.428	SPK IN N CB 10FT E/O BCR @ NE COR EMERSON AVE & GARFIELD AVE 51FT E & 20FT N/O C/L INT	Y 9810
RIVERA (1994)	0154.517	L&T IN SLY CB WASHINGTON BLVD 33FT WLY OF C/L C/L PROD SAYBROOK AVE STAMPED (1S 3125)	Y 9814
RIVERA (1994)	0154.978	FC TAG IN CB @ C B @ NE COR WASHINGTON BLVD & SAYBROOK AVE 95FT N & 38FT E/O C/L INT	Y 9815
RIVERA (1994)	0160.279	RD BM TAG IN CB 1FT S/O BCR @ NW COR WASHINGTON BLVD & PASSONS BLVD 66FT N & 30FT W/O C/L INT	Y 9817
RIVERA (1994)	0235.826	RD BM TAG 24FT N/O BCR @ NE COR BEVERLY BLVD & ATLANTIC BLVD 91FT N & 42FT E/O C/L INT	Y 9829
RIVERA (1994)	0216.764	RD BM TAG S WALL C B 1FT W/O CF @ NW COR BEVERLY BL & MONTEBELLO BL 77FT N & 46FT W/O C/L INT	Y 9833
RIVERA (1994)	0216.674	RD BM TAG IN CB S END C B @ NE COR BEVERLY BL & MONTEBELLO BL 105FT N & 34FT E/O C/L INT	Y 9834
RIVERA (1994)	0206.613	RD BM TAG IN E CB S END C B @ NE COR BEVERLY BLVD & POPLAR AVE 45FT N & 20FT E/O C/L INT	Y 9836
RIVERA (1994)	0179.196	RD BM TAG IN S CB E END C B @ SE COR BEVERLY RD & PARAMOUNT BLVD 100FT E & 35FT S/O C/L INT	Y 9837
RIVERA (1994)	0191.492	L&BN IN CB 2FT S/O BCR @ SE COR LA VERNE AVE (TO THE S) & WHITTIER BLVD 45FT S & 19FT E/O C/L INT	Y 9842
RIVERA (1994)	0216.142	L&BRAD 0.5FT S/O BCR @ SW COR WILCOX AVE & MADISON AVE 36FT S & 25FT W/O C/L INT	Y 9845
RIVERA (1994)	0189.215	RD BM TAG 1FT W/O CF IN S END C B @ NW COR UNION PACIFIC AVE & DITMAN AVE 41FT N & 21FT W/O C/L INT	Y 9858
RIVERA (1994)	0189.642	RD BM TAG IN W CB 1FT N/O BCR @ NW COR HERBERT AV & UNION PACIFIC AV 41FT N & 20FT W/O C/L INT	Y 9859
RIVERA (1994)	0189.560	L&BN IN CB 2FT E/O BCR @ NE COR UNION PACIFIC AVE & HERBERT AVE 47FT E & 20FT N/O C/L INT	Y 9860
RIVERA (1994)	0173.723	CE TAG IN SLY CB 35FT SLY OF C/L TELEGRAPH RD ON C/L PROD DUNCAN AVE	Y 9861
RIVERA (1994)	0255.416	L&T IN S CB 40FT S/O C/L 3RD ST ON C/L PROD SUNOL DR	Y 9864

QUAD-YEAR	ELEV	DESCRIPTION (INCLUDE QUAD AND YEAR IN DESCRIPTION)	BM NUMBER
RIVERA (1994)	0275.235	L&T IN DEPRESSED CB 2FT E/O BCR @ SE COR 3RD ST & ARIZONA AVE 41FT S & 36FT E/O C/L INT	Y 9865
RIVERA (1994)	0262.053	PK NAIL IN CB NR BCR @ SE COR 3RD ST & LA VERNE AVE 50FT E & 40FT S/O C/L INT	Y 9866
RIVERA (1994)	0246.251	L&BN IN CB 1FT E/O BCR @ SE COR BEVERLY BLVD & GERHART AVE 64FT E & 40FT S/O C/L INT	Y 9867
RIVERA (1994)	0141.287	L&T IN CB 1FT N/O BCR @ SE COR EASTERN AVE & HARBOR ST 62FT S & 42FT E/O C/L INT	Y 9870
RIVERA (1994)	0141.439	L&T NR CTR CB RET @ SW COR EASTERN AVE & HARBOR ST 49FT W & 39FT S/O C/L INT	Y 9871
RIVERA (1994)	0175.450	CE TAG IN CB NR BCR @ SE COR LA VERNE AVE & OLYMPIC BLVD 44FT E & 35FT S/O C/L INT	Y 9874
RIVERA (1994)	0294.859	L&BN IN NW COR BR #B53-1734 OVER POMONA FRWY 55FT S & 30FT W/O C/L INT MENDIK AVE & 1ST ST	Y 9878
RIVERA (1994)	0405.873	L&T IN CB 2.5FT W/O BCR @ SE COR ROWAN AVE & FOLSOM ST 30FT E & 24FT S/O C/L INT	Y 9879
RIVERA (1994)	0414.550	L&T IN S CB 1FT W/O BCR @ SW COR BLANCHARD ST & DITMAN AVE 35FT W & 18FT S/O C/L INT	Y 9880
RIVERA (1994)	0434.765	L&SPK IN TOP OF 3FT RET WALL @ WLY ANGLE PT 30FT E/O C/L PROD HERBERT AVE (TO THE N) 10FT S/O CF & 50FT S/O C/L CITY TERRACE DR	Y 9882
RIVERA (1994)	0322.134	L&T IN CB 32FT W/O C/L EASTERN AVE ON C/L PROD BLANCHARD ST	Y 9883
RIVERA (1994)	0432.869	LACS TAG IN W CB EASTERN AVE ON C/L PROD SHERIFF RD 32FT W/O C/L INT	Y 9886
RIVERA (1994)	0386.124	L&BR 0.5FT S/O BCR 30FT E/O C/L HERBERT AVE & 70FT S/O C/L MEDFORD ST	Y 9889
BASELINE (1990)	0175.108	RAMSET IN CB 1FT N/O BCR 53FT N/O C/L WHITTIER BL & 15FT W/O C/L REDMAN AVE (TO THE N)	Y 10105
RIVERA (1994)	0188.557	FC BR CAP MON IN NE COR OF RR BRIDGE ABUT OVER LA RIVER 230FT S & 77FT E/O C/L INT DOWNEY RD & BANDINI BLVD MKD (006-02790 1963)	Y 10115
RIVERA (1994)	0136.206	BM TAG IN C B 1FT N/O CF @ NW COR EASTERN AVE & RICKENBACKER RD 79FT W & 27FT N/O C/L INT	Y 10119

QUAD-YEAR	ELEV	DESCRIPTION (INCLUDE QUAD AND YEAR IN DESCRIPTION)	BM NUMBER
RIVERA (1994)	0138.731	L&BR IN E CB @ BLDG #4680 875FT N/O C/L BANDINI BLVD & 40FT E/O C/L EASTERN AVE	Y 10120
RIVERA (1994)	0210.731	RD BM TAG IN CB 5FT W/O BCR @ NW COR BLUFF RD & MOUNTAIN VIEW AVE 42FT W & 20FT N/O C/L INT	Y 10122
BASELINE (1990)	0176.879	PK&W IN CB 20FT E/O BCR @ SE COR SLAUSON AVE & PACIFIC BL 100FT E & 35FT S/O C/L INT MKD (BM)	Y 10147
BASELINE (1990)	0148.596	RD BM TAG IN CB 1FT W/O BCR @ SE COR SLAUSON AVE & ATLANTIC BL 50FT E & 41FT S/O C/L INT	Y 10197
BASELINE (1990)	0156.027	RD BM TAG IN N CB SLAUSON AVE 40FT N/O C/L @ OR NR C/L PROD TRIANGLE DR (FR THE S) 2FT W/O W END C B	Y 10198
BASELINE (1990)	0158.971	RD BM TAG IN CB 1FT W/O BCR @ SW COR SLAUSON AVE & GREENWOOD AVE 66FT W & 42FT S/O C/L INT	Y 10199
BASELINE (1990)	0148.329	RD BM TAG IN NE COR OF CONC HDWL EDISON TOWER #258D4 VICCEN 1 193FT E/O E END OF BRIDGE OVER RIO HONDO RIVER & 40FT S/O C/L TELEGRAPH RD	Y 10200
BASELINE (1990)	0142.747	2IN CALIF DIV HWY DISC IN S CB 4FT W/O BCR @ N/W COR TELEGRAPH RD & PARAMOUNT BL 54FT W & 40FT N/O C/L INT MKD (BELL K4 1941 #5 1972)	Y 10201
BASELINE (1990)	0138.793	RD BM TAG IN S CB 1FT E/O BCR @ NE COR ROSEMEAD BLVD & TELEGRAPH RD 63FT E & 42FT N/O C/L INT	Y 10202
BASELINE (1990)	0141.711	RD BM TAG IN CB 1FT E/O BCR @ SE COR NORWALK BL & TELEGRAPH RD 91FT E & 42FT S/O C/L INT	Y 10203
RIVERA (1994)	0222.128	DPW BM TAG IN E CB 1FT N/O BCR @ NE COR INDIANA ST & WHITTIER BLVD 59FT N & 29FT E/O C/L INT	Y 10242
RIVERA (1994)	0315.101	L&T IN S CB 1FT W/O BCR @ SW COR RECORD AVE & CESAR E CHAVEZ AVE 37FT W & 30FT S/O C/L INT	Y 10244
RIVERA (1994)	0265.820	L&T IN S CB 1FT W/O BCR @ SW COR CESAR E CHAVEZ AVE & CARMELITA AVE 30FT S & 32FT W/O C/L INT	Y 10245
RIVERA (1994)	0300.865	L&SPK IN N CB 8FT E/O BCR @ NE COR EASTERN AVE & CESAR E CHAVEZ AVE 79FT E & 30FT N/O C/L INT	Y 10246
RIVERA (1994)	0313.211	DPW BM TAG IN S CB 1FT E/O BCR @ SE COR FORD BL & CESAR E CHAVEZ AVE 37FT E & 30FT S/O C/L INT	Y 10247
RIVERA (1994)	0313.802	L&T IN W CB 2FT N/O BCR @ NW COR FORD BLVD & CESAR E CHAVEZ AVE 45FT N & 20FT W/O C/L INT	Y 10248

QUAD-YEAR	ELEV	DESCRIPTION (INCLUDE QUAD AND YEAR IN DESCRIPTION)	BM NUMBER
RIVERA (1994)	0407.636	DPW BM TAG IN CB 1FT E/O BCR @ NE COR GARVEY AVE & HITCHOCK DR 54FT E & 40FT N/O C/L INT	Y 10249
BASELINE (1990)	0192.421	DPW BM TAG IN W CB 1FT S/O BCR @ SW COR ISORA SR & DUFEE AVE 46FT S & 20FT W/O C/L INT	Y 10254
BASELINE (1990)	0210.103	DPW BM TAG IN CB 1FT W/O BCR @ NW COR ROSEMEAD BL & SAN GABRIEL BL 85FT W & 38FT N/O C/L INT	Y 10255
BASELINE (1990)	0244.444	DPW BM TAG 1FT S/O BCR @ SE COR SAN GABRIEL BL & DARLINGTON ST 44FT S & 40FT E/O C/L INT	Y 10256
BASELINE (1990)	0248.503	DPW BM TAG 1FT N/O BCR @ NE COR SAN GABRIEL BL & DARLINGTON ST 44FT N & 40FT E/O C/L INT	Y 10257
BASELINE (1990)	0276.609	DPW BM TAG IN CB 1FT N/O BCR @ NE COR MUSCATEL AVE & SAN GABRIEL BL 47FT N & 46FT E/O C/L INT	Y 10258
BASELINE (1990)	0169.465	L&BR IN CB 8FT N/O BCR 38FT SLY OF LOCH AVON DR & 29FT WLY OF NORWALK BL	Y 10259
BASELINE (1990)	0165.721	L&DN IN N CB 1FT W/O BCR @ NW COR SLAUSON AVE & DOWNEY RD 77FT W & 33FT N/O C/L INT	Y 10568
BASELINE (1990)	0168.503	L&BR IN CB RET 9FT W/O BCR @ NE COR SLAUSON AVE & DOWNEY RD 24FT W/O W SPRR (ELY OF 2 L&BR'S)	Y 10569
RIVERA (1994)	0173.185	DPW BM TAG IN W CB DOWNEY RD 0.25MI N/O INT SLAUSON AVE @ BLDG #5501 (10FT N/O N WALL C B)	Y 10570
RIVERA (1994)	0181.934	DPW BM TAG IN W CB 1FT S/O BCR @ SW COR DOWNEY RD & LEONIS BLVD 70FT S & 24FT W/O C/L INT	Y 10571
RIVERA (1994)	0183.717	L&SPK IN W CB 3FT N/O BCR @ NW COR DOWNEY RD & 45TH ST 36FT N & 36FT W/O C/L INT	Y 10572
RIVERA (1994)	0275.494	2IN BR DISC IN CTR CB RET RAMP @ SW COR INDIANA ST & 6TH ST (TO THE W) 25FT W & 26FT S/O C/L INT MKD (LAMTA ESE-021 1994)	Y 10573
RIVERA (1994)	0280.594	DPW BM TAT IN E CB 3FT S/O BCR @ NE COR INDIAN ST & 6TH ST (TO THE E) 33FT N & 22FT E/O C/L INT	Y 10574
RIVERA (1994)	0403.260	DPW BM TAG IN S CB 1FT E/O ELY END C B @ BLDG #616 35FT S/O C/L MONTEREY PASS RD	Y 10575
RIVERA (1994)	0403.230	DPW BM TAG IN N CB 1FT E/O ELY END C B @ BLDG #617 35FT N/O C/L MONTEREY PASS RD	Y 10576

QUAD-YEAR	ELEV	DESCRIPTION (INCLUDE QUAD AND YEAR IN DESCRIPTION)	BM NUMBER
RIVERA (1994)	0381.482	DPW BM TAG IN N CB 66FT E/O BCR @ NE COR GARVEY AVE & ATLANTIC BLVD 120FT E & 38FT N/O C/L INT (@ FIRE HYD)	Y 10577
RIVERA (1994)	0385.348	DPW BM TAG IN S CB 8FT W/O BCR @ SW COR GARVEY AVE & YNEZ AVE 40FT W & 40FT S/O C/L INT	Y 10578
RIVERA (1994)	0384.852	RAM SET IN S CB 1FT E/O BCR @ SE COR GARVEY AVE & YNEZ AVE 40FT S & 33FT E/O C/L INT	Y 10579
RIVERA (1994)	0380.596	DPW BM TAG IN N CB 1FT E/O BCR @ NW COR GARVEY AVE & GARFIELD AVE 66FT W & 40FT N/O C/L INT	Y 10580
RIVERA (1994)	0389.116	DPW BM TAG IN W CB 8FT N/O BCR @ NW COR EMERSON AVE & GARFIELD AVE 40FT N & 31FT W/O C/L INT	Y 10581
RIVERA (1994)	0370.915	L&BR IN S CB 5FT E/O BCR @ SE COR EMERSON AVE & ORANGE AVE 50FT E & 20FT S/O C/L INT	Y 10582
RIVERA (1994)	0356.822	L&RCE TAG #9548 IN W CB 2FT S/O BCR @ SW COR EMERSON AVE & NEW AVE 47FT S & 30FT W/O C/L INT	Y 10583
RIVERA (1994)	0305.499	L&T IN CB RET 9FT N/O BCR @ SE COR EMERSON PL & DEL MAR AVE 37FT S & 34FT E/O C/L INT	Y 10584
BASELINE (1990)	0279.729	L&BR IN W CB 1FT S/O BCR @ SW COR EMERSON PL & SAN GABRIEL BLVD 40FT S & 38FT W/O C/L INT	G 10585
RIVERA (1994)	0189.560	LRG PK IN W CB OF BRIDGE OVER LA RIVER 39FT S/O NW COR BRIDGE 231FT S & 27FT W/O C/L INT DOWNEY RD & BANDINI BLVD	Y 10586
RIVERA (1994)	0317.521	2IN BR DISC IN W DRWY 95FT S/O BCR @ SW COR 1ST ST & INDIANA ST 130FT S & 22FT W/O C/L INT MKD (LAMTA ESE-019 1994)	Y 10587
RIVERA (1994)	0299.532	LACE TAG IN W CB 4FT N/O BCR @ SW COR MEDNIK AVE & CESAR E CHAVEZ AVE 41FT S & 33FT W/O C/L INT	Y 10588
RIVERA (1994)	0246.237	DPW BM TAG IN W CB 6FT N/O BCR @ NW COR 4TH ST & LA VERNE AVE 35FT N & 19FT W/O C/L INT	Y 10589
RIVERA (1994)	0245.828	DPW BM TAG IN E CB 2FT S/O BCR @ SE COR 4TH ST & LA VERNE AVE 31FT S & 19FT E/O C/L INT	Y 10590
RIVERA (1994)	0213.319	DPW BM TAG IN E CB 3FT N/O BCR @ NE COR 6TH ST & LA VERNE AVE 47FT N & 19FT E/O C/L INT	Y 10591
RIVERA (1994)	0212.414	DPW BM TAG IN W CB 3FT S/O BCR @ SW COR 6TH ST & LA VERNE AVE 33FT S & 19FT W/O C/L INT	Y 10592

QUAD-YEAR	ELEV	DESCRIPTION (INCLUDE QUAD AND YEAR IN DESCRIPTION)	BM NUMBER
RIVERA (1994)	0191.603	2IN BR DISC IN S CB 3FT E/O BCR @ SE COR LA VERNE AVE (TO THE S) & WHITTIER BLVD 37FT E & 28FT S/O C/L INT MKD (LAMTA ESE 031 1994)	Y 10593
RIVERA (1994)	0173.976	DPW BM TAG IN N CB 3FT W/O BCR @ NE COR OLYMPIC BLVD & ATLANTIC BLVD 74FT E & 36FT N/O C/L INT	Y 10594
RIVERA (1994)	0172.471	DPW BM TAG IN W CB 2FT N/O BCR @ SW COR OLYMPIC BLVD & ATLANTIC BLVD 77FT S & 35FT W/O C/L INT	Y 10595
RIVERA (1994)	0139.386	L&SPK IN E CB 1FT N/O BCR @ NE COR EASTERN AVE & WASHINGTON BLVD 57FT N & 39FT E/O C/L INT	Y 10596
RIVERA (1994)	0136.422	DPW BM TAG IN E CB 1FT N/O BCR @ SE COR EASTERN AVE & RICKENBACKER RD 63FT S & 39FT E/O C/L INT	Y 10597
BASELINE (1990)	0166.351	2IN BR DISC IN CONC WK 15.5FT W/O BCR @ NE COR SLAUSON AV & BOYLE AV (TO THE N) 63FT E & 41FT N/O C/L INT MKD (CITY OF VERNON MON) 4FT N/O CF	Y 10598
RIVERA (1994)	0303.046	DPW BM TAG IN S CB 14FT W/O BCR @ SW COR 3RD ST & GAGE AVE (TO THE N) 75FT W & 41FT S/O C/L INT	Y 10599
RIVERA (1994)	0299.957	DPW BM TAG IN N CB 20FT E/O C/L DRWY E/O BCR @ NE COR 3RD ST & GAGE AVE (TO THE N) 89FT E & 41FT N/O C/L INT	Y 10600
RIVERA (1994)	0304.421	DPW BM TAG IN W CB 2FT S/O BCR @ SW COR 3RD ST & EASTERN AVE 78FT S & 34FT W/O C/L INT	Y 10601
RIVERA (1994)	0300.926	DPW BM TAG IN SW COR OF C B 7FT N/O BCR 96FT NLY OF C/L 3RD ST & 33FT ELY OF C/L EASTERN AVE	Y 10602
RIVERA (1994)	0273.869	DPW BM TAG IN N CB 3FT W/O BCR @ NW COR 3RD ST & ARIZONA AVE 43FT W & 41FT N/O C/L INT	Y 10603
RIVERA (1994)	0408.930	DPW BM TAG IN W CB 4FT N/O BCR @ NW COR ROWAN AVE & FOLSOM ST 31FT N & 20FT W/O C/L INT	Y 10604
RIVERA (1994)	0405.802	DPW BM TAG IN E CB 3FT N BCR @ NE COR BLANCHARD ST & TOWNSEND AVE 33FT N & 20FT E/O C/L INT	Y 10605
RIVERA (1994)	0418.581	DPW BM TAG IN W CB 1FT N/O BCR @ NW COR DITMAN AVE & BLANCHARD ST 35FT N & 20FT W/O C/L INT	Y 10606
RIVERA (1994)	0439.555	DPW BM TAG IN E CB 2FT N/O BCR @ NE COR POMEROY ST & CITY TERRACE DR 73FT N & 30FT E/O C/L INT	Y 10607
RIVERA (1994)	0440.284	DPW BM TAG IN W CB 2FT S/O BCR @ SW COR POMEROY ST & CITY TERRACE DR 33FT S & 30FT W/O C/L INT	Y 10608

QUAD-YEAR	ELEV	DESCRIPTION (INCLUDE QUAD AND YEAR IN DESCRIPTION)	BM NUMBER
RIVERA (1994)	0430.339	DPW BM TAG IN N CB 2FT E/O BCR @ NE COR HERBERT AVE (TO THE N) & CITY TERRACE DR 73FT E & 40FT N/O C/L INT	Y 10609
RIVERA (1994)	0378.626	L&T IN C B 10FT W/O BCR @ NW COR MEDFORD ST & BONNIE BEACH PL 56FT W & 32FT N/O C/L INT	Y 10610
RIVERA (1994)	0409.204	DPW BM TAG IN CB 6FT W/O BCR @ SWLY COR 32FT 140FT SLY OF C/L EASTERN AVE & 32FT WLY OF C/L MEDFORD ST	Y 10611
RIVERA (1994)	0412.269	DPW BM TAG IN CB 7FT W/O BCR @ SE COR MEDFORD ST & EASTERN AVE 32FT ELY & 40FT S/O C/L INT	Y 10612
RIVERA (1994)	0441.604	DPW BM TAG IN CB 1FT W/O BCR @ NW COR EASTERN AVE & TIM AVE 43FT W & 45FT N/O C/L INT	Y 10613
RIVERA (1994)	0457.782	DPW BM TAG IN CONC WALK 5FT S/O BCR 1FT E/O CF @ SE COR EASTERN AVE & CITY TERRACE DR 90FT S & 33FT E/O C/L INT (N END OF C B)	Y 10614
RIVERA (1994)	0317.762	DPW BM TAG IN N CB 1FT E BCR @ NE COR BLANCHARD ST & HUMPHREYS AVE 31FT E & 15FT N/O C/L INT	Y 10615
RIVERA (1994)	0303.699	DPW BM TAG IN S CB 1FT E/O BCR @ SE COR LOPEZ AVE & BLANCHARD ST 30FT E & 15FT S/O C/L INT	Y 10616
RIVERA (1994)	0301.143	DPW BM TAG IN N CB 1FT E/O BCR @ NE COR ROWAN AVE & CESAR CHAVEZ AVE 35FT E & 28FT N/O C/L INT	Y 10617
RIVERA (1994)	0436.076	DPW BM TAG IN E CB 1FT N/O BCR @ NE COR EASTERN AVE & SHERRIFF RD 62FT N & 32FT E/O C/L INT	Y 10618
RIVERA (1994)	0236.925	DPW BM TAG IN N CB 12FT W/O BCR @ NW COR BEVERLY BLVD & ATLANTIC BLVD 87FT W & 41FT N/O C/L INT (NR WLY END C B)	Y 10619
RIVERA (1994)	0231.984	DPW BM TAG IN N CB 16FT W/O BCR @ NW COR BEVERLY BLVD & MARGARET AVE 81FT W & 40FT N/O C/L INT	Y 10620
RIVERA (1994)	0232.193	DPW BM TAG IN S CB 1FT E/O BCR @ SE COR BEVERLY BLVD & MARGARET AVE 63FT E & 40FT S/O C/L INT	Y 10621
RIVERA (1994)	0239.439	DPW BM TAG IN S CB 1FT W/O BCR @ SW COR BEVERLY BLVD & BRADSHAW AVE 46FT W & 42FT S/O C/L INT	Y 10622
RIVERA (1994)	0239.191	DPW BM TAG IN E CB 1FT N/O BCR @ NE COR BEVERLY BLVD & BRADSHAW AVE 71FT N & 20FT E/O C/L INT	Y 10623

✓ JAD-YEAR	ELEV	D E S C R I P T I O N (INCLUDE QUAD AND YEAR IN DESCRIPTION)	BM NUMBER
RIVERA (1994)	0218.845	L&T IN W CB 3FT N/O BCR @ NW COR BRADSHAWE AVE & 6TH ST 36FT N & 15FT W/O C/L INT	Y 10624
RIVERA (1994)	0217.862	L&T IN S CB 1FT W/O BCR @ SW COR BRADSHAWE AVE & 6TH ST 44FT W & 18FT S/O C/L INT	Y 10625
RIVERA (1994)	0189.982	DPW BM TAG IN W CB 1FT S/O BCR @ SW COR ALLEY N/O WHITTIER BLVD & BRADSHAWE AVE 19FT S & 15FT W/O C/L INT	Y 10626
RIVERA (1994)	0191.403	DPW BM TAG IN W CB 1FT N/O BCR @ NW COR ALLEY N/O WHITTIER BLVD & LEONARD AVE 19FT N & 15FT W/O C/L INT	Y 10627
RIVERA (1994)	0193.888	DPW BM TAG IN W CB 12FT S/O BCR @ SW COR ALLEY N/O WHITTIER BLVD & FINDLAY AVE 28FT S & 17FT W/O C/L INT	Y 10628
RIVERA (1994)	0189.905	L&T IN W CB 60FT N/O BCR @ NW COR WESTSIDE DR & ALLSTON ST 111FT N & 20FT W/O C/L INT	Y 10629
RIVERA (1994)	0192.494	SPK IN W CB 100FT S/O BCR @ SW COR WHITTIER BL & SAYBROOK AVE 161FT S & 20FT W/O C/L INT (ON C/L PROD ALLEY WAY TO THE E)	Y 10630
RIVERA (1994)	0187.792	DPW BM TAG IN S CB 10FT E/O C/L PROD BRADSHAWE AVE (TO THE N) & WHITTIER BLVD 40FT S & 10FT E/O C/L INT	Y 10631
RIVERA (1994)	0201.468	DPW BM TAG IN S CB 1FT E/O BCR @ SE COR GARFIELD AVE & WHITTIER BLVD 78FT E & 42FT S/O C/L INT	Y 10632
RIVERA (1994)	0201.352	DPW BM TAG IN W CB 1FT N/O BCR @ NW COR GARFIELD AVE & WHITTIER BLVD 78FT N & 42FT W/O C/L INT (IN W WALL C B)	Y 10633
RIVERA (1994)	0199.641	DPW BM TAG IN W CB 10FT N/O BCR @ NW COR WILCOX AVE & WHITTIER BLVD 86FT N & 30FT W/O C/L INT (@ N END C B)	Y 10634
RIVERA (1994)	0199.727	DPW BM TAG IN E CB 55FT N/O BCR @ NE COR WILCOX AVE & WHITTIER BLVD 94FT N & 25FT E/O C/L INT	Y 10635
RIVERA (1994)	0245.608	DPW BM TAG IN W CB 1FT S/O BCR @ SW COR WILCOX AVE & BEVERLY BLVD 75FT S & 32FT W/O C/L INT	Y 10636
RIVERA (1994)	0247.382	DPW BM TAG IN N CB 36FT E/O BCR @ NE COR WILCOX AVE & WHITTIER BLVD 93FT E & 35FT N/O C/L INT	Y 10637

QUAD-YEAR	ELEV	DESCRIPTION (INCLUDE QUAD AND YEAR IN DESCRIPTION)	BM NUMBER
RIVERA (1994)	0249.481	DPW BM TAG IN S CB 12FT W/O BCR @ SW COR VAIL AVE & BEVERLY BLVD 48FT W & 38FT S/O C/L INT	Y 10638
RIVERA (1994)	0248.842	DPW BM TAG IN S CB 17FT E/O BCR @ SE COR VAIL AVE & BEVERLY BLVD 63FT E & 38FT S/O C/L INT	Y 10639
RIVERA (1994)	0222.814	L&BR IN N CB 44FT N/O BCR @ NW COR BEVERLY BLVD & TAYLOR AVE 102FT N & 20FT W/O C/L INT	Y 10640
RIVERA (1994)	0222.708	L&BR IN E CB 45FT N/O BCR @ NE COR BEVERLY BLVD & TAYLOR AVE 103FT N & 20FT E/O C/L INT	Y 10641
RIVERA (1994)	0223.717	DPW BM TAG IN W CB 40FT S/O BCR @ SW COR 10TH ST & BEVERLY BLVD 104FT S & 20FT W/O C/L INT	Y 10642
RIVERA (1994)	0206.320	DPW BM TAG IN W CB 6FT S/O BCR @ SW COR POPLAR AVE & BEVERLY BLVD 79FT S & 20FT W/O C/L INT (IN N END C B)	Y 10643
RIVERA (1994)	0177.406	DPW BM TAG IN N CB 2FT W/O BCR @ NW COR PINE ST & BEVERLY BLVD 103FT W & 25FT N/O APPROX C/L INT	Y 10644
RIVERA (1994)	0177.979	DPW BM TAG IN S CB 2FT E/O BCR @ SE COR PINE ST & BEVERLY BLVD 106FT E & 22FT S/O C/L APPROX INT	Y 10645
RIVERA (1994)	0179.070	DPW BM TAG IN N CB 28FT E/O BCR @ NE COR BEVERLY BLVD & PARAMOUNT BLVD 84FT E & 42FT N/O C/L INT	Y 10646
RIVERA (1994)	0181.853	DPW BM TAG IN W CB 36FT N/O BCR @ NW COR BEVERLY BLVD & ROSEMEAD BLVD 104FT N & 58FT W/O C/L INT	Y 10647
RIVERA (1994)	0183.973	DPW BM TAG IN N CB 3FT E/O BCR @ NE COR BEVERLY BLVD & LINDSEY AVE 52FT E & 38FT N/O C/L INT	Y 10648
RIVERA (1994)	0188.513	DPW BM TAG IN N CB 3FT E/O BCR @ NE COR UNION PACIFIC AV & DITMAN AV 42FT E & 20FT N C/L INT	Y 10649
RIVERA (1994)	0189.489	DPW BM TAG IN N CB 2FT W/O BCR @ NW COR UNION PACIFIC AV & DOWNEY RD 41FT W & 20FT N C/L INT	Y 10650
RIVERA (1994)	0188.599	L&BR IN S CB 3FT E/O BCR @ SE COR DOWNEY RD & UNION PACIFIC AVE 42FT E & 20FT S/O C/L INT	Y 10651
RIVERA (1994)	0173.997	DPW BM TAG IN E CB 28FT N/O BCR @ NE COR DUNCAN AV & TELEGRAPH RD 72FT NLY & 19FT ELY OF C/L INT	Y 10652
RIVERA (1994)	0164.528	DPW BM TAG IN N CB 2FT W/O BCR @ NW COR KERN AVE & TELEGRAPH RD 60FT W & 31FT N/O C/L INT	Y 10653

QUAD-YEAR	ELEV	DESCRIPTION (INCLUDE QUAD AND YEAR IN DESCRIPTION)	BM NUMBER
RIVERA (1994)	0160.374	DPW BM TAG IN W CB 1FT S/O BCR @ NW COR LA VERNE AVE & TELEGRAPH RD 66FT NLY & 19FT W/O C/L INT (@ C B)	Y 10654
RIVERA (1994)	0160.181	DPW BM TAG IN E CB 9FT N/O BCR @ NE COR LA VERNE AVE & TELEGRAPH RD 71FT NLY & 19FT E/O C/L INT (@ C B)	Y 10655
RIVERA (1994)	0151.899	DPW BM TAG IN SLY CB 3FT E/O BCR @ SELY COR FERGUSON DR & TELEGRAPH RD 86FT E/O APPARENT C/L TELEGRAPH RD & 28FT S/O C/L FERGUSON DR (@ C B)	Y 10656
RIVERA (1994)	0146.857	DPW BM TAG IN NLY CB 9FT W/O BCR @ NW COR TELEGRAPH RD & HOEFNER AVE 58FT W & 42FT N/O C/L INT (NR C B)	Y 10657
RIVERA (1994)	0150.655	DPW BM TAG IN N CB 3FT W/O BCR @ NW COR GASPAR AVE & TELEGRAPH RD 65FT W & 41FT N/O C/L INT	Y 10658
RIVERA (1994)	0150.814	DPW BM TAG IN N CB 1FT E/O BCR @ NE COR GASPAR AVE & TELEGRAPH RD 55FT E & 41FT N/O C/L INT	Y 10659
RIVERA (1994)	0147.035	DPW BM TAG IN N CB 8FT W/O BCR @ NW COR TUBEWAY AVE & TELEGRAPH RD 71FT W & 41FT N/O C/L INT	Y 10660
RIVERA (1994)	0147.666	DPW BM TAG IN E CB 1FT N/O BCR @ NE COR TUBEWAY AVE & TELEGRAPH RD 80FT N & 33FT E/O C/L INT	Y 10661
RIVERA (1994)	0147.790	DPW BM TAG IN S CB 4FT W/O BCR @ SW COR TELEGRAPH RD & WASHINGTON BLVD 154FT WLY & 42FT S/O C/L INT	Y 10662
RIVERA (1994)	0148.493	DPW BM TAG IN N CB 2FT W/O BCR @ NW COR TELEGRAPH RD & WASHINGTON BLVD 69FT W & 42FT N/O C/L INT	Y 10663
RIVERA (1994)	0168.822	DPW BM TAG IN E CB 3FT N/O BCR @ NE COR GARFIELD AVE & WASHINGTON BLVD 108FT N & 41FT E/O C/L INT	Y 10664
RIVERA (1994)	0172.747	DPW BM TAG IN S CB 2FT E/O BCR @ SE COR VAIL AVE & WASHINGTON BLVD 57FT E & 42FT S/O C/L INT	Y 10665
RIVERA (1994)	0171.092	DPW BM TAG IN N CB 35FT E/O BCR @ NE COR VAIL AVE & WASHINGTON BLVD 95FT E & 42FT N/O C/L INT	Y 10666
RIVERA (1994)	0174.670	DPW BM TAG IN N CB 3FT W/O BCR @ NW COR MAPLE AVE & WASHINGTON BLVD 59FT W & 42FT N/O C/L INT	Y 10667

QUAD-YEAR	ELEV	DESCRIPTION (INCLUDE QUAD AND YEAR IN DESCRIPTION)	BM NUMBER
RIVERA (1994)	0177.952	DPW BM TAG IN N CB 136FT E/O BCR @ NE COR MAPLE AVE & WASHINGTON BLVD 192FT E & 42FT N/O C/L INT (@ C B)	Y 10668
RIVERA (1994)	0185.596	DPW BM TAG IN W CB 48FT N/O BCR @ NW COR GREENWOOD AVE & WASHINGTON BLVD 122FT N & 28FT W/O C/L INT (@ C B)	Y 10669
RIVERA (1994)	0189.233	FC BR DISC IN MOC RET 3FT N/O CF 54FT N/O C/L WASHINGTON BL & 31FT E/O APPARENT C/L BLUFF RD @ NW COR BRIDGE MKD (BM 053-02001 1979)	Y 10670
RIVERA (1994)	0160.905	DPW BM TAG IN N CB 15FT E/O BCR @ NE COR WASHINGTON BLVD & PARAMOUNT BLVD 96FT E & 44FT N/O C/L INT	Y 10671
RIVERA (1994)	0160.486	DPW BM TAG IN N CB 50FT W/O BCR @ NW COR WASHINGTON BLVD & ROSEMEAD BLVD 120FT W & 38FT N/O C/L INT	Y 10672
RIVERA (1994)	0159.779	DPW BM TAG IN N CB 6FT E/O BCR @ NE COR PASSONS BL & WASHINGTON BL 103FT E & 41FT N/O C/L INT	Y 10673
RIVERA (1994)	0157.928	DPW BM TAG IN N CB 3FT W/O BCR @ NW COR PIONEER BLVD & WASHINGTON BLVD 75FT W & 44FT N/O C/L INT	Y 10674
RIVERA (1994)	0157.563	DPW BM TAG IN S CB 3FT E/O BCR @ SE COR PIONEER BLVD & WASHINGTON BLVD 73FT E & 42FT S/O C/L INT	Y 10675
RIVERA (1994)	0185.808	DPW BM TAG IN W CB 3.5FT N/O BCR @ NW COR GARFIELD AV & FERGUSON DR 58FT N & 35FT W/O C/L INT	Y 10676
RIVERA (1994)	0184.582	L&T IN S CB 0.5FT E/O BCR @ SE COR GARFIELD AVE & FERGUSON DR 77FT E & 20FT S/O C/L INT	Y 10677
RIVERA (1994)	0211.143	DPW BM TAG IN W CB 10FT N/O BCR @ NW COR POPLAR AVE & POPLAR WAY 71FT N & 20FT W/O C/L INT (@ HSE #117)	Y 10678
RIVERA (1994)	0211.047	DPW BM TAG IN W CB 15FT S/O BCR @ SW COR BLUFF RD & MOUNTAIN VIEW AVE 45FT S & 20FT W/O C/L INT	Y 10679
RIVERA (1994)	0211.304	L&T IN W CB 5FT N/O BCR @ NW COR BLUFF RD & MINES AVE 47FT N & 20FT W/O C/L INT	Y 10680
RIVERA (1994)	0210.525	DPW BM TAG IN W CB 47FT S/O BCR @ SW COR BLUFF RD & MINES AVE 83FT S & 20FT W/O C/L INT	Y 10681
RIVERA (1994)	0202.337	RAMSET IN W CB 2FT S/O BCR @ SW COR BLUFF RD & BEACH ST 31FT S & 14FT W/O C/L INT	Y 10682

QUAD-YEAR	ELEV	DESCRIPTION (INCLUDE QUAD AND YEAR IN DESCRIPTION)	BM NUMBER
RIVERA (1994)	0180.661	DPW BM TAG IN W CB 3FT N/O BCR @ NW COR BLUFF RD & DATE ST 34FT N & 20FT W/O C/L INT	Y 10683
RIVERA (1994)	0179.435	DPW BM TAG IN N CB 3FT W/O BCR @ NW COR BLUFF RD & OAKWOOD ST 48FT W & 20FT N/O C/L INT	Y 10684
RIVERA (1994)	0179.434	L&BR IN W CB 5FT S/O BCR @ SW COR BLUFF RD & OAKWOOD ST 36FT S & 20FT W/O C/L INT	Y 10685
RIVERA (1994)	0170.866	DPW BM TAG IN W CB 1FT S/O BCR @ SW COR BLUFF RD & MAYNARD RD 51FT S & 20FT W/O C/L INT	Y 10686
RIVERA (1994)	0157.997	FC BRASS DISC @ NW COR OF BRIDGE ABUT 80FT E & 28.5FT N/O C/L INT SLAUSON AVE & BLUFF RD MKD (053-00955)	Y 10687
RIVERA (1994)	0154.661	DPW BM TAG IN N CB 2FT W/O BCR @ NW COR BLUFF RD & SLAUSON AVE 52FT W & 46FT N/O C/L INT	Y 10688
BASELINE (1990)	0179.120	DPW BM TAG IN E CB 3FT N/O BCR @ NE COR PASSONS BLVD & WHITTIER BLVD 67FT N & 43FT E/O C/L INT	Y 10689
BASELINE (1990)	0178.493	DPW BM TAG IN W CB 27FT N/O BCR @ NW COR PASSONS BLVD & WHITTIER BLVD 99FT N & 20FT W/O C/L INT	Y 10690
RIVERA (1994)	0176.450	PK&L IN E CB 1FT N/O BCR @ NE COR PASSONS BLVD & HOLBROOK ST 43FT N & 20FT E/O C/L INT	Y 10691
RIVERA (1994)	0176.059	DPW BM TAG IN E CB 6FT S/O BCR @ SE COR PASSONS BLVD & HOLBROOK ST 48FT S & 20FT E/O C/L INT	Y 10692
RIVERA (1994)	0173.037	DPW BM TAG IN E CB 6FT N/O BCR @ NE COR PASSONS BLVD & TOWNLEY DR 52FT N & 20FT E/O C/L INT	Y 10693
RIVERA (1994)	0172.347	DPW BM TAG IN E CB 6FT S/O BCR @ SE COR PASSONS BLVD & TOWNLEY DR 51FT S & 20FT E/O C/L INT	Y 10694
RIVERA (1994)	0167.605	DPW BM TAG IN N CB 5FT E/O BCR @ NE COR PASSONS BLVD & MINES AVE 58FT E & 38FT N/O C/L INT	Y 10695
RIVERA (1994)	0164.188	DPW BM TAG IN S CB 5FT E/O BCR @ SE COR PASSONS BLVD & MAJORIE AVE 52FT E & 18FT S/O C/L INT	Y 10696
BASELINE (1990)	0269.236	DPW BM TAG IN E CB 6FT N/O BCR @ NE COR RUSH ST & SAN GABRIEL BL 67FT N & 42FT E/O C/L INT	Y 10697
BASELINE (1990)	0278.478	DPW BM TAG IN E CB 14FT S/O BCR @ SE COR SAN GABRIEL BL & KLINGERMAN ST 56FT S & 42FT E/O C/L INT	Y 10698

QUAD-YEAR	ELEV	DESCRIPTION (INCLUDE QUAD AND YEAR IN DESCRIPTION)	BM NUMBER
BASELINE (1990)	0278.747	L&BR IN W CB 1FT N/O BCR @ NW COR SAN GABRIEL BL & BARUCH ST 41FT N & 42FT W/O C/L INT	Y 10699
BASELINE (1990)	0266.340	DPW BM TAG IN E CB 3FT S/O BCR @ SW COR GARVALIA AVE & SAN GABRIEL BL 43FT S & 42FT W/O C/L INT	Y 10700
BASELINE (1990)	0293.938	DPW BM TAG IN W CB 10FT S/O BCR @ SW COR HELLMAN AVE & SAN GABRIEL BL 49FT S & 36FT W/O C/L INT	G 10701
BASELINE (1990)	0294.787	DPW BM TAG IN N CB 3FT W/O BCR @ NW COR HELLMAN AVE & SAN GABRIEL BL 68FT W & 18FT N/O C/L INT	G 10702
BASELINE (1990)	0272.984	DPW BM TAG IN N CB 2FT W/O BCR @ NW COR GARVEY AV & SAN GABRIEL BL 55FT W & 38FT N/O C/L INT	G 10703
BASELINE (1990)	0216.739	L&BR IN S CB 56FT W/O BCR @ SW COR SAN GABRIEL BL & LINCOLN AVE 114FT W & 42FT S/O C/L INT	Y 10704
BASELINE (1990)	0214.550	RD DEPT 2IN BR CAP MON IN WELL 6IN DN ON C/L INT SAN GABRIEL BL & LINCOLN AVE MKD (1982)	Y 10705
BASELINE (1990)	0228.806	LA CO DPW 2IN BR CAP MON IN WELL 6IN DN ON C/L SAN GABRIEL BL 193FT W/O C/L PLAZA DR	Y 10706
BASELINE (1990)	0227.567	DPW BM TAG IN E CB N END OF C B 38FT S/O BCR @ SE COR SAN GABRIEL BL & PLAZA DR 113FT S & 25FT E/O C/L INT	Y 10707
BASELINE (1990)	0131.794	DPW BM TAG IN N CB 40FT W/O BCR @ NW COR TELE- GRAPH RD & ALBURTIS AVE (TO THE N) 100FT W & 40FT N/O C/L INT	Y 10708
BASELINE (1990)	0132.034	DPW BM TAG IN S CB 20FT E/O BCR @ SE COR ORR & DAY RD & TELEGRAPH RD 97FT E & 38FT S/O C/L INT	Y 10709
BASELINE (1990)	0132.211	DPW BM TAG IN N CB 2FT E/O BCR @ NE COR ORR & DAY RD & TELEGRAPH RD 78FT E & 38FT N/O C/L INT	Y 10710
BASELINE (1990)	0140.984	DIV OF HWYS 3IN BR DISC IN SIDEWALK RET @ NW COR TELEGRAPH RD & ON-OFF RAMP (605 FRWY) 48FT N/O C/L & 109FT W/O C/L CEDARDALE ST (TO THE S)	Y 10711
BASELINE (1990)	0139.932	L&T IN W CB 17FT S/O BCR @ SW COR TELEGRAPH RD & HASTY AVE 78FT S & 18FT W/O C/L INT	Y 10712
BASELINE (1990)	0138.121	DIV OF HWYS 1 1/2IN BR DISC @ SW CB RET 11FT E/O BCR TRUE AVE & TELEGRAPH RD (E END ISLE) 49FT S & 26FT W/O C/L INT	Y 10713